

Operating instructions

ALF - Station



JS Aupperle GmbH - Untere Wängen 1 - D- 73119 Zell u. A.
Phone: +49(0) 7164/ 14717-0



1 Table of contents

1	Table of contents	1
2	Safety instruction.....	2
2.1	Symbols and explanation	2
2.2	Work safety instructions	3
2.3	Safety regulations.....	4
2.4	Requirements for the installation	5
3	General information	6
3.1	Manufacturer / Type	6
3.2	Type approval	6
3.3	Copyright and industrial property rights.....	6
3.4	Labelling	6
3.5	Application.....	6
3.6	Description of the	7
3.7	Technical data	7
3.8	Note on the operating instructions.....	7
4	Installation / set-up	8
4.1	Drilling template.....	8
4.2	Fastening	9
4.3	Connection options.....	10
4.4	Disassembly / connection from behind.....	11
4.5	Assembly	15
5	Device description	16
6	Commissioning	17
7	Mandatory calibration.....	18
8	Operation	19
8.1	Increase tyre pressure.....	19
8.2	Reduce tyre pressure	20
9	Maintenance/ repair	21
9.1	Maintenance.....	21
9.2	Repair.....	21
10	Guarantee	22
11	Take-back and recycling	23
12	Spare parts	24
12.1	Spare parts hose nozzle.....	24
12.2	Spare parts protective cover	25
12.3	Spare parts control housing	26

2 Safety instruction

2.1 Symbols and explanation



Occupational safety symbol

This symbol is used for all work safety instructions in these operating instructions where there is a risk to the life or health of persons. These instructions must always be followed very carefully. All work safety instructions must be passed on to other users. In addition to the instructions given in the operating instructions, all other generally applicable safety and accident prevention regulations must also be observed.



Caution

This "Caution" notice appears in all passages of these operating instructions that must be carefully observed in order to comply with the guidelines, regulations, instructions and correct operating procedures and to prevent damage to the product and/or persons.



Hint

This note "Note" appears in all passages of these operating instructions that must be carefully observed.

To prevent damage to the product and parts of the appliance, always follow the guidelines, regulations and instructions in the operating instructions.



2.2 Work safety instructions

The **ALF® - Station** has been developed and built in accordance with the relevant basic health and safety requirements set out in the EU directives.

Hint



This product can be dangerous if used improperly. Children must not operate this appliance. Incorrect operation can cause the tyre to explode!

All persons involved in the maintenance, commissioning and operation of the **ALF® - Station** must read and understand the entire operating instructions beforehand.

Hint



The ALF® - Station tyre inflator is designed exclusively for compressed air / nitrogen. Any use outside this purpose as well as modifications to the product are considered improper use. The manufacturer is not liable for damage caused by improper use. The risk lies solely with the user.

Proper use of the product also includes compliance with the manufacturer's instructions with regard to installation, operation and maintenance.

All work in connection with installation, adjustment and maintenance must be carried out by qualified personnel. When operating

ALF® - Station tyre inflator, all local safety and accident prevention regulations must always be observed.

ALF - Station



2.3 Safety regulations

Hint

The operator must monitor that:

- *the occupational health and safety and accident prevention regulations as well as the occupational health and safety regulations of these operating instructions are fully complied with in all measures*
- *Measures to avoid hazards must be taken immediately!*

The operator of the tyre inflation gauge must ensure that:

- *the operating instructions can be inspected at the place of use by the persons responsible for operation*
- *knowledge of the operating instructions must be a prerequisite for operating the tyre inflation gauge*
- *any faults that occur must be reported to the operator*
- *Persons who carry out maintenance work on the tyre inflation gauge are expressly authorised and qualified to do so*
- *the safety, occupational health and safety and hazard notices on the appliance or place of use are in a clearly legible condition*
- *no unauthorised conversions or modifications that could lead to improper use are carried out by persons entrusted with the operation or maintenance of the appliance*
- *a decommissioned tyre inflator must be secured by the operator against unauthorised use*





2.4 Requirements for the installation

Caution



The ALF® - Station may only be operated with filtered, de-oiled and dried compressed air. The compressed air supply must therefore be equipped with the necessary compressed air maintenance unit. This includes the cyclone effect in the air filter housing for separating coarse mechanical particles and condensed water, the air filter with depth filter insert for separating fine mechanical particles and the pressure reducer. Furthermore, an air dryer must be installed in the air flow direction. The air dryer must realise a pressure dew point of the compressed air of at least the ambient temperature up to which the ALF® - Station is to be operated.

The ALF® - Station must not be used for filling and testing ballast tyres filled with water or tyres treated with corrosive agents.

Caution



When connecting the ALF® - Station to the operator's compressed air network, ensure that it is properly connected to it.

If necessary, fit an intermediate piece and bracket (both available on request) to the existing compressed air connection.

3 General information

3.1 Manufacturer / Type

JS Aupperle GmbH
Untere Wängen 1
D - 73119 Zell u. A.
Type: **ALF® - Station**

3.2 Type approval

The **ALF® - Station** tyre pressure gauge has been type-tested by the
Physikalisch - Technische - Bundesanstalt and approved.

Type examination:

EN-24-M-PTB-0034

Tyre inflator **ALF -**

3.3 Copyright and industrial property rights

The copyright to these operating instructions remains with the manufacturer.
Furthermore, all rights are reserved, in particular in the event that a patent is granted
or a utility model is registered.
Infringements are subject to compensation.

3.4 Labelling

Calibration plate/ type plate:	Are attached to the top right of the protective cover.
---------------------------------------	--

3.5 Application

The tyre inflation gauge referred to in the operating instructions may only be used to
check, inflate and deflate tyres for motor vehicles (it is **not suitable** for tyres on
bicycles, children's vehicles, wheelbarrows and aircraft, for example).

The compressed air specifications available at the place of use must be observed, as
well as those of the tyre and vehicle manufacturers (e.g. posted table regarding
inflation pressures depending on tyre size and load).



3.6 Description of the

The **ALF® - Station** is a manual tyre pressure gauge for floor mounting. It is used to check and correct the tyre pressure for motor vehicles. The desired tyre pressure can be changed using the +/- buttons.

The tyre pressure is displayed on the pressure gauge when the lever nipple is connected to the tyre.

To set the desired tyre pressure, briefly press the + button (the tyre pressure is increased).

To reduce the tyre pressure, press the button.

If you release the + or - button, the actual pressure in the tyre is displayed.

3.7 Technical data

Height:	1520 mm
Width:	270 mm
Length:	200 mm
Weight:	20 kg
Pressure supply:	max. 12 bar
maximum filling pressure:	10 bar
Reading accuracy:	0.1 bar
Hose length:	8 metres
Temperature range:	- 10°C to +50°C

3.8 Note on the operating instructions

Hint

For reasons of clarity, these operating instructions do not contain all the detailed information on the tyre inflation gauge

ALF® - Station (Aupperle - Air - Filler).

If you require further information or if specific problems arise that are not covered in sufficient detail in these operating instructions, you can request the necessary information directly from the manufacturer (see cover sheet).



We would also like to point out that the content of these operating instructions is part of an existing agreement or legal relationship. All obligations arise from the respective purchase contract, which also contains the complete and solely valid warranty and liability regulations.



4 Installation / set-up

Hint



The air compressor and the compressed air system must be equipped with the necessary compressed air maintenance units, including an air dryer, to prevent dirt and water from accumulating in the ALF® - Station pipe system.

The ALF® - Station must not be used for filling and testing ballast tyres filled with water or tyres treated with corrosive agents.

Hint



A covered location is recommended when using the ALF® - Station.

4.1 Drilling template

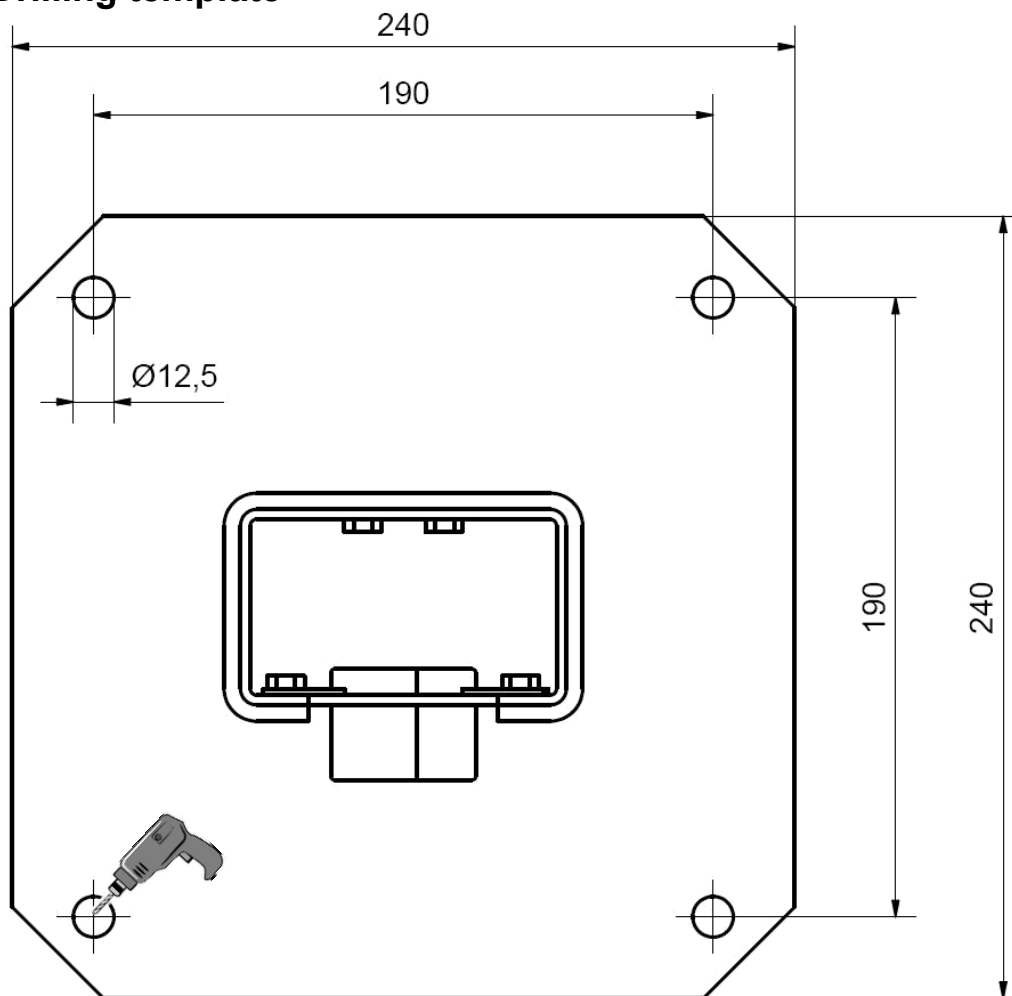

(This drawing is not to scale)



4.2 Fastening

Please fix the column to the ground using the ground anchors supplied.

Technical data:

Drill hole diameter: 10 mm
Min. drill hole depth: 110 mm
Width across flats: 17 mm

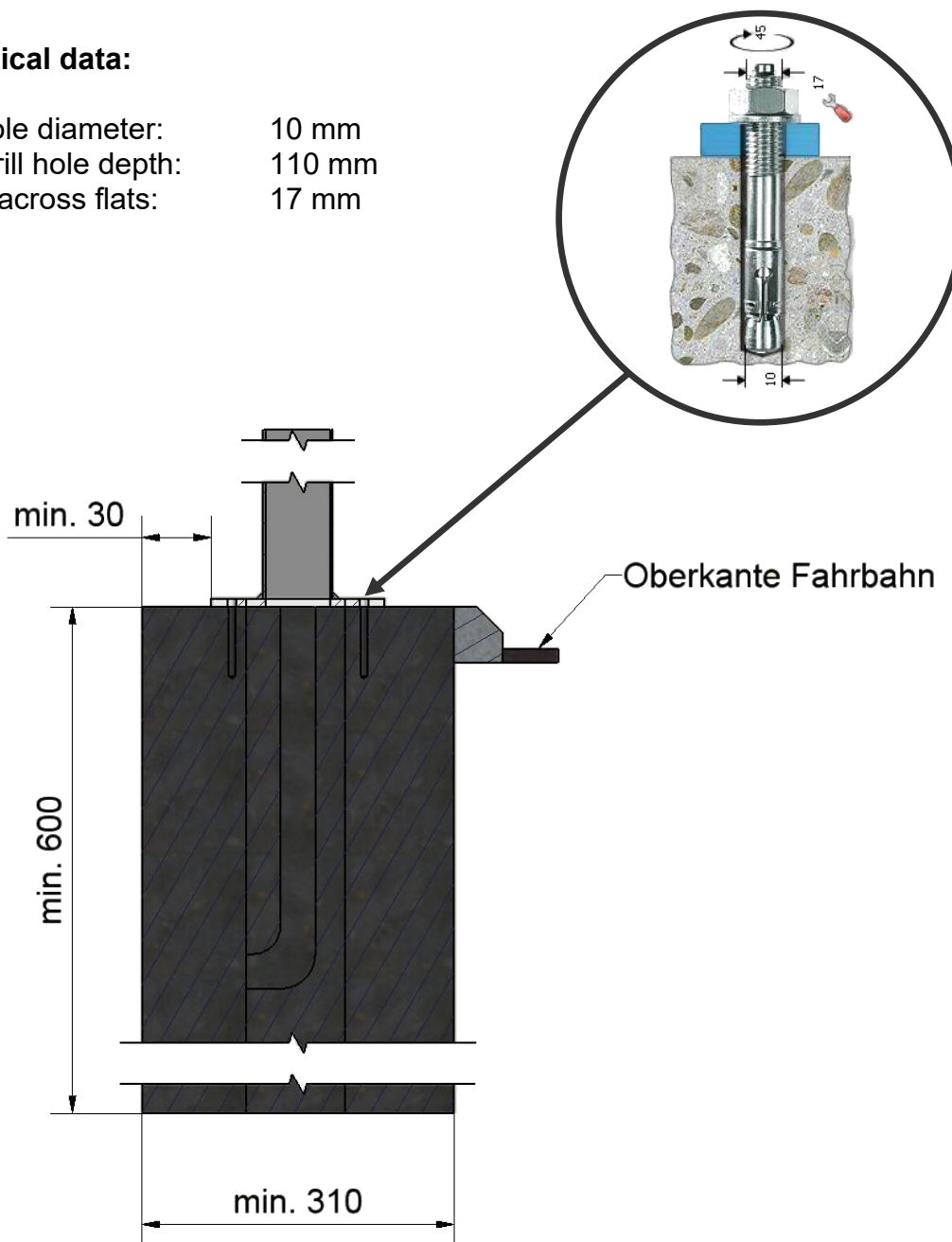

To ensure that the column is stable, the foundation must correspond to the dimensions specified above.
There should be an empty pipe in the centre of the foundation for the water and air pipes to pass through.
This empty conduit must be sealed watertight on the house side.

ALF - Station



4.3 Connection options

Hint



Before starting installation, make sure that the compressed air line is depressurised.

With the **ALF® - Station**, you have the option of supplying the device with compressed air from below or from behind.

A connection from below is provided ex works.

If you do not have a connection option from below, please follow points 1 to 3.3 under 4.4 Dismantling / connection from behind.



4.4 Disassembly / connection from behind

Hint



Before you start dismantling, please disconnect ALF® - Station from the compressed air supply. Please ensure that the supply line is no longer pressurised.

1. remove the rectangular black cover cap.

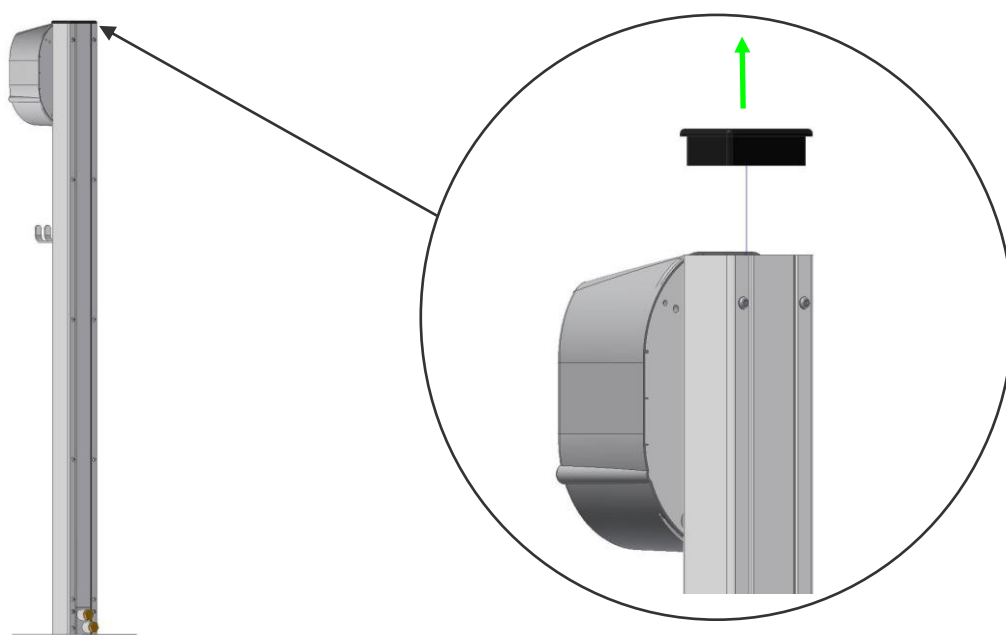

2. use the special spanner supplied to unscrew the 10 screws on the back of the cover
cover on the back using the special spanner supplied.

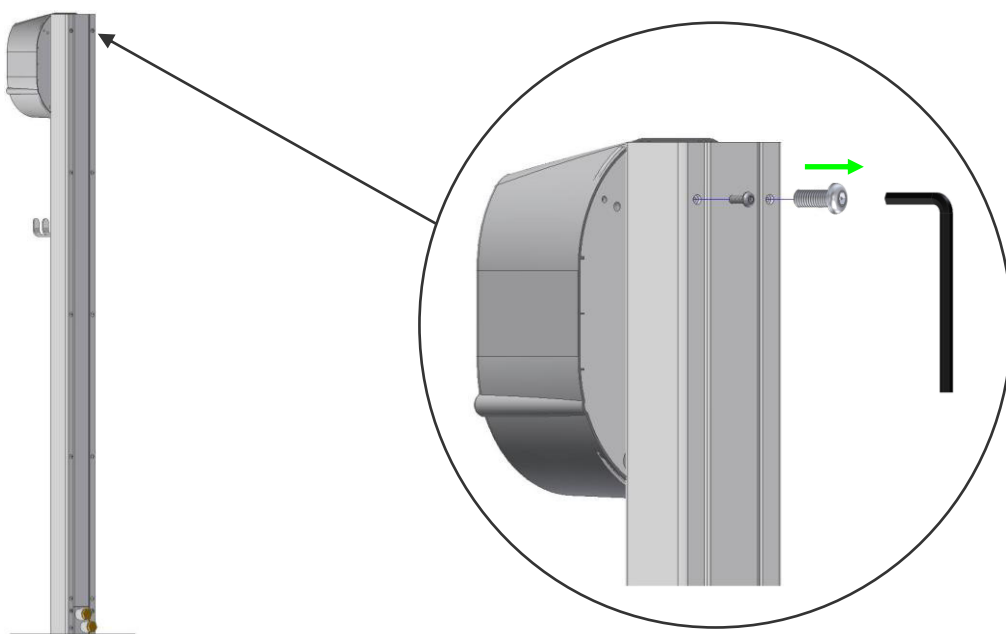

ALF - Station



3 Now pull the cover upwards out of the column.

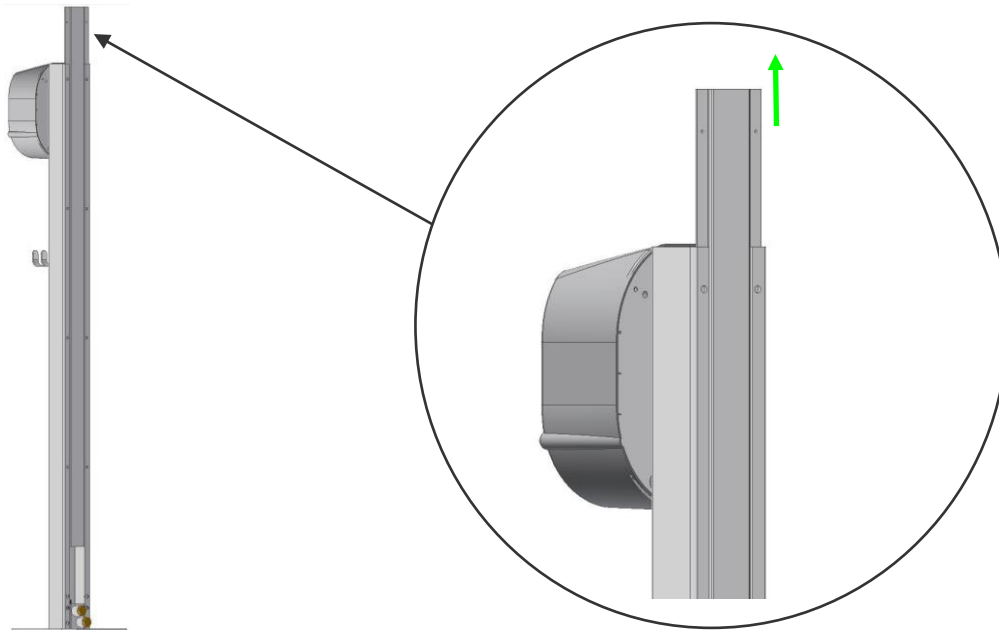

3.1 Insert the pneumatic hose hanging downwards out of the column into the pneumatic screw connection.

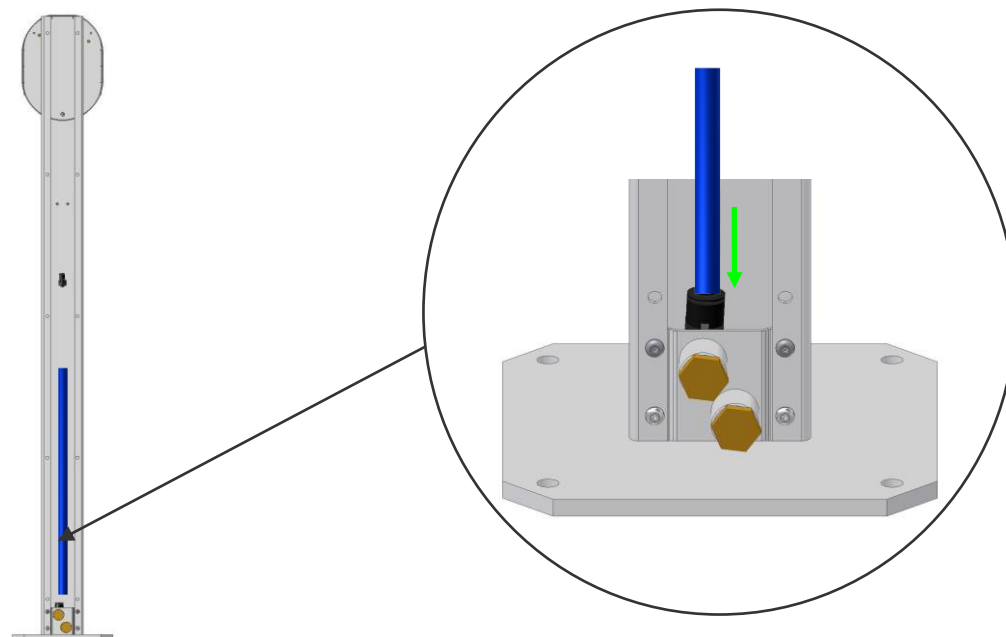



3.2 Remove the upper screw plug from the sleeve.

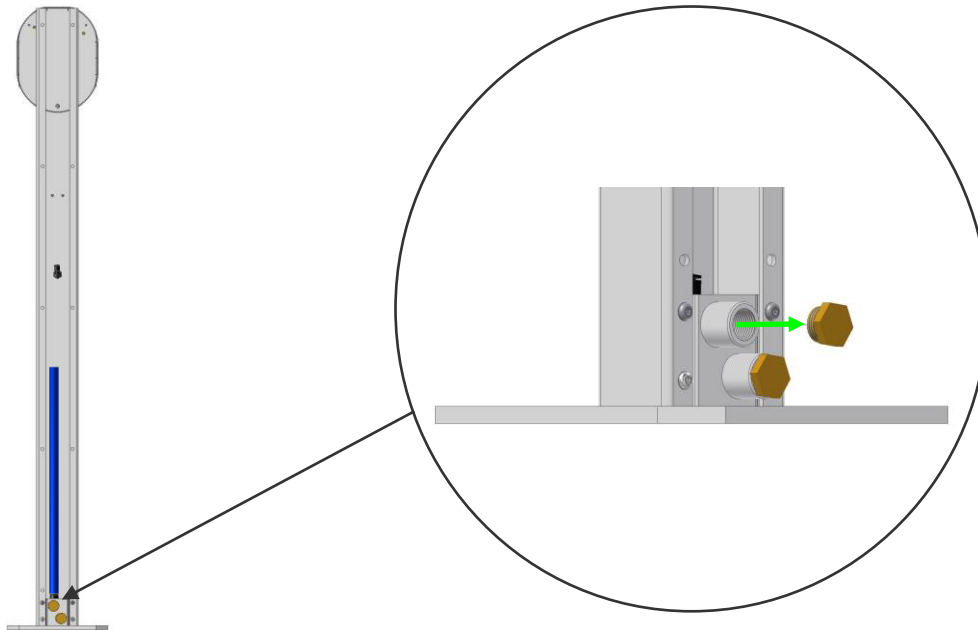

3.3 Screw your pressure connection into the 1/2" socket.

4. remove the two pneumatic hoses from the pneumatic
pneumatic screw connections on the rear of your **ALF® - Station**

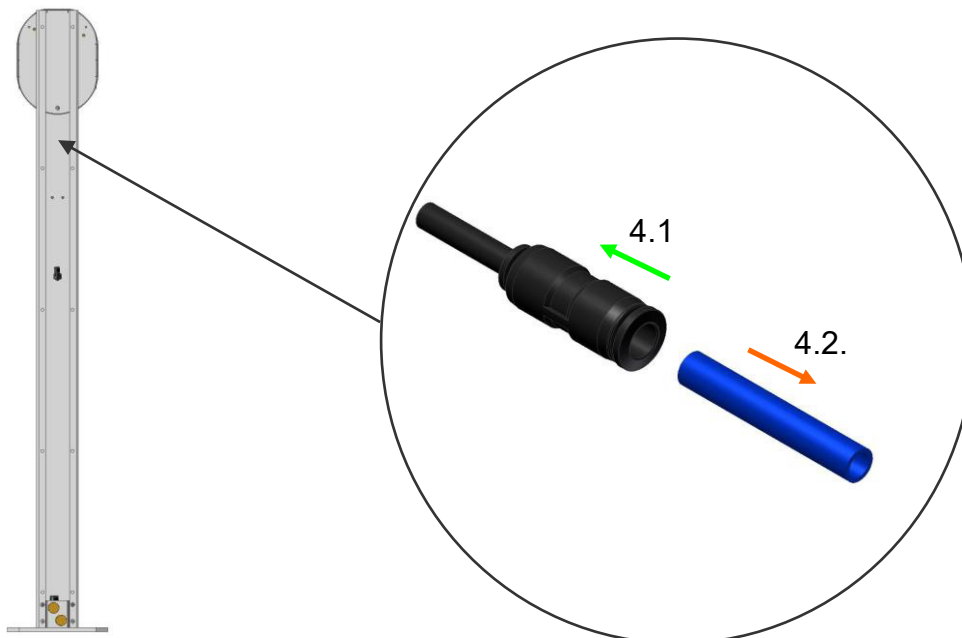

4.1 Push the ring (black) at the bottom end of the pneumatic
pneumatic screw connection upwards and hold it there.

4.2 Now pull the pneumatic hose (blue) out of the pneumatic fitting with the other
hand.

the pneumatic screw connection.



5. use the special spanner supplied to remove the 3 fixing screws on the back of your fixing screws on the back of your **ALF® - Station**.



Caution

The ALF® - Station can fall down when the last screw is loosened.

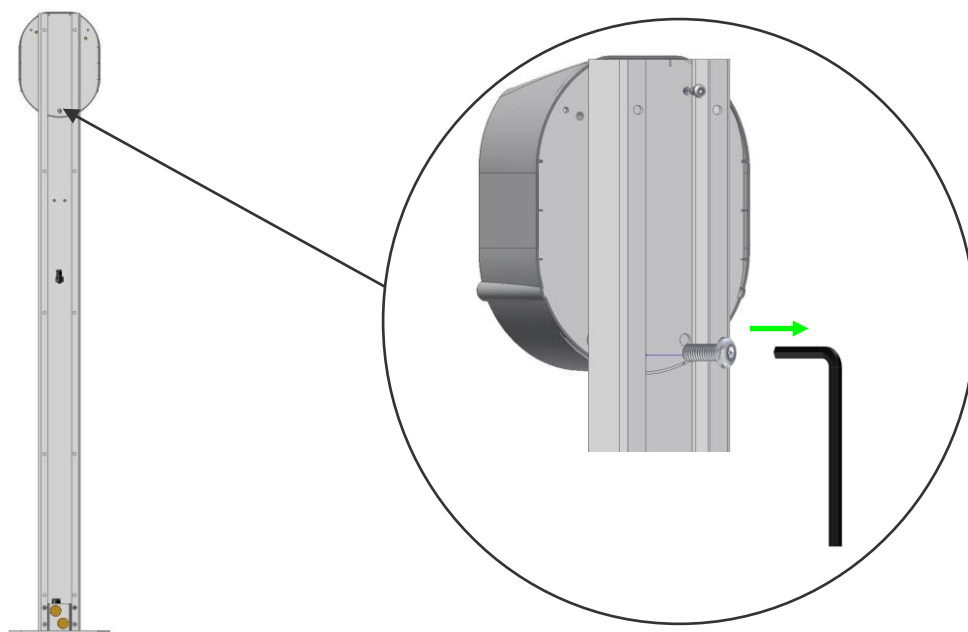

6. remove the **ALF® - Station** to the front.

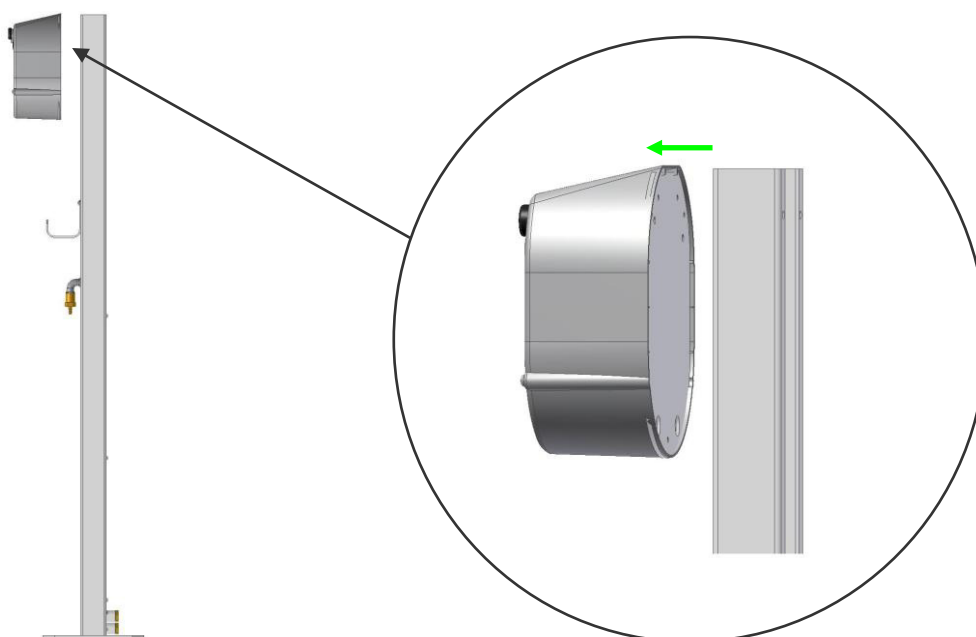

ALF - Station



4.5 Assembly

To reattach your **ALF® - Station** to the column, please follow points 1 to 6 under 4.4 Dismantling in reverse order.

ALF - Station



5 Device description

ALF - Station

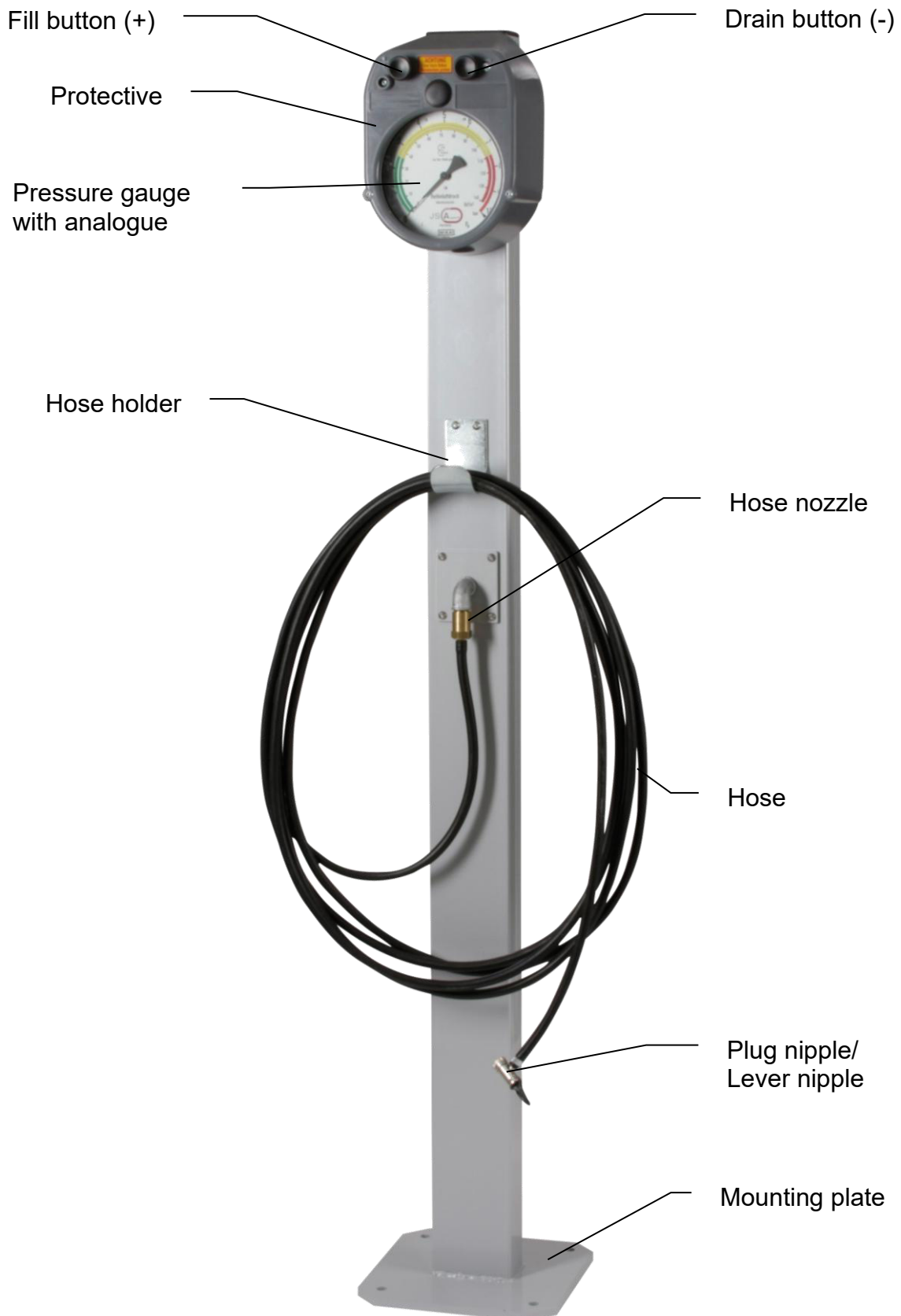



6 Commissioning

1. Unpack the device.
2. Check whether there is any damage to the packaging and/or the appliance.

Hint



If the ALF® - Station is damaged during transport, please contact your specialist dealer or the manufacturer.

3. Attach the **ALF® - Station** to the installation site using the 4 ground anchors supplied.

Caution



Before connecting the tyre inflation gauge to your stationary compressed air system, make sure that there is no more pressure in the line.

4. Connect the pressure line to the **ALF® - Station**.

Caution



***Hold the lever nipple firmly with one hand before pressing the fill button (+) with the other.
The plug-in nipple can flap uncontrollably through the air.***

5. Press the fill button (+).
If air comes out of the lever nipple, the appliance is ready for operation.

Hint



If no air comes out of the ALF® - Station, please check your connections and your compressed air network.



7 Mandatory calibration

The calibration law applies with regard to calibration and test intervals.

In the Federal Republic of Germany, measuring devices for checking tyre pressure must be calibrated in accordance with the calibration law of 23.03.1992 (last amended on 03.07.2008). The period of validity of the calibration is 2 years after the end of the calendar year in which the tyre pressure gauge was last calibrated. The person who uses or keeps the tyre pressure gauge available is responsible for the calibration (Eichgesetz § 35 [2], 1).



8 Operation



Hint

Please refer to your vehicle's operating instructions for the correct tyre pressure.

8.1 Increase tyre pressure

1. Take the lever nipple with tube and carry it to the tyre.
2. Remove the valve cap from your tyre valve.
3. Attach the lever plug nipple to the tyre valve.
4. The pressure in the tyre is displayed on the pressure gauge.
5. To increase the tyre pressure, press the inflation button (+) for approx. 1 sec. on the inflation button (+).
6. After you have released the inflation button (+), the current tyre pressure is displayed on the pressure gauge.
7. Repeat points 6 and 7 until the desired tyre pressure is reached.

Caution



*Pressing the inflation button (+) for too long can cause the tyre to burst.
"Only fill briefly and check in between"*

8. Quickly remove the lever nipple from the tyre valve to prevent excessive pressure loss in the tyre.
9. Roll up the hose again on the existing hose holder.



8.2 Reduce tyre pressure

1. Take the lever nipple with tube and carry it to the tyre.
2. Remove the valve cap from your tyre valve.
3. Attach the lever plug nipple to the tyre valve.
4. The pressure in the tyre is displayed on the pressure gauge.
5. To reduce the tyre pressure, press the deflation button (-) for approx. 1 sec. on the deflation button (-).
6. Once you have released the drain button (-), the current tyre pressure is displayed on the pressure gauge.
7. Repeat points 6 and 7 until the desired tyre pressure is reached.
8. Quickly remove the lever plug from the tyre valve to prevent excessive pressure loss in the tyre.
9. Roll up the hose again on the existing hose holder.

Hint



Rapid inflation, deflation and precise testing is only possible if the lever nipple is in good condition and is positioned exactly on the tyre valve.

If the lever nipple is pressed too little onto the tyre valve, the tyre pressure can be increased, but it is not possible to check the tyre pressure precisely.



9 Maintenance / Repair



Caution

Before working on the tyre inflator, disconnect it from the stationary compressed air network.

9.1 Maintenance

Period	Examination
Before each operation	<ul style="list-style-type: none">Check the zero position of the pressure gauge
Weekly	<ul style="list-style-type: none">Check the filling hose and plug nippleCheck the compressed air connection <p>If leaks or wear are detected, replace damaged parts.</p>
Half-yearly	<ul style="list-style-type: none">Check tyre inflation gauge and compressed air connection for leaks.Is the calibration sticker on the appliance still valid? If not, a new calibration is required.

9.2 Repair

The **ALF-Station** has undergone internal type testing and is subject to calibration in Germany and most EU countries. We therefore recommend that you send the **ALF-Station** to a specialist dealer or the manufacturer in the event of malfunctions or for repairs.



10 Guarantee

The scope and period of the warranty are regulated in the manufacturer's terms and conditions of sale and delivery. The operating instructions valid at the time of delivery shall always apply to warranty and liability claims, unless otherwise agreed. The following applies in addition to the terms and conditions of sale and delivery: No warranty or liability is accepted for damage caused for the following reasons, insofar as this is permissible:

- Non-observance of the operating instructions.
- Parts that have been damaged by force by the customer or third parties.
- If, without our written consent, the customer or a third party has tampered with or carried out unauthorised repairs to the appliance.
- If additional equipment or operating materials not recommended by us have been used and the customer does not provide proof that the claimed defect is not due to this.
- If damage is caused by force majeure, water damage, fire damage or connection of the appliance to incorrect compressed air, water and power connections.
- By inadequately trained and insufficiently instructed operating and maintenance personnel of the operator.
- When using non-original spare parts.
- If the necessary maintenance and service work has not been carried out on a regular basis.
- If the safety regulations in sections 2.2 and 2.3 are not observed.
- If the product is not used as intended, or if it is incorrectly installed or commissioned, or if it is operated in an unauthorised manner.
- If intended use is not guaranteed and the tyre inflation gauge is not operated in accordance with the contractually agreed conditions of use.
- if the calibration seal / calibration seal has been damaged or removed.

The operator is responsible for compliance with these provisions:

- That the safety regulations in accordance with sections 2.2 and 2.3 are complied with.
- That improper use, incorrect installation or commissioning and unauthorised operation are excluded and that, in addition
- Intended use is guaranteed and the tyre inflation gauge is operated in accordance with the contractually agreed conditions of use.



11 Take-back and recycling

Taking back old appliances



The adjacent symbol means that the old appliance must be disposed of separately from household waste. Please help and make a contribution to environmental protection by not disposing of the old appliance with household waste.

Hint



Appliances must not be disposed of with household waste. Please contact us for proper disposal. Telephone: +49(0)7164 - 14717 - 0

12 Spare parts

12.1 Spare parts hose nozzle

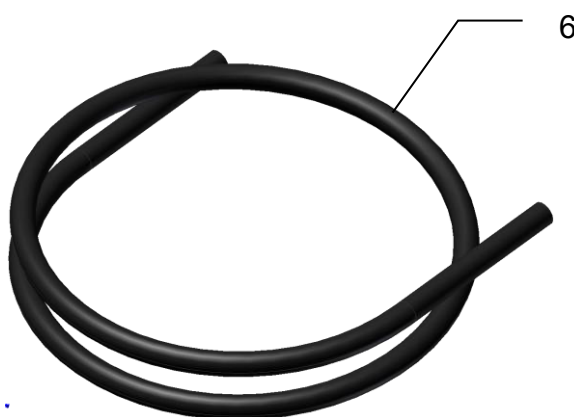
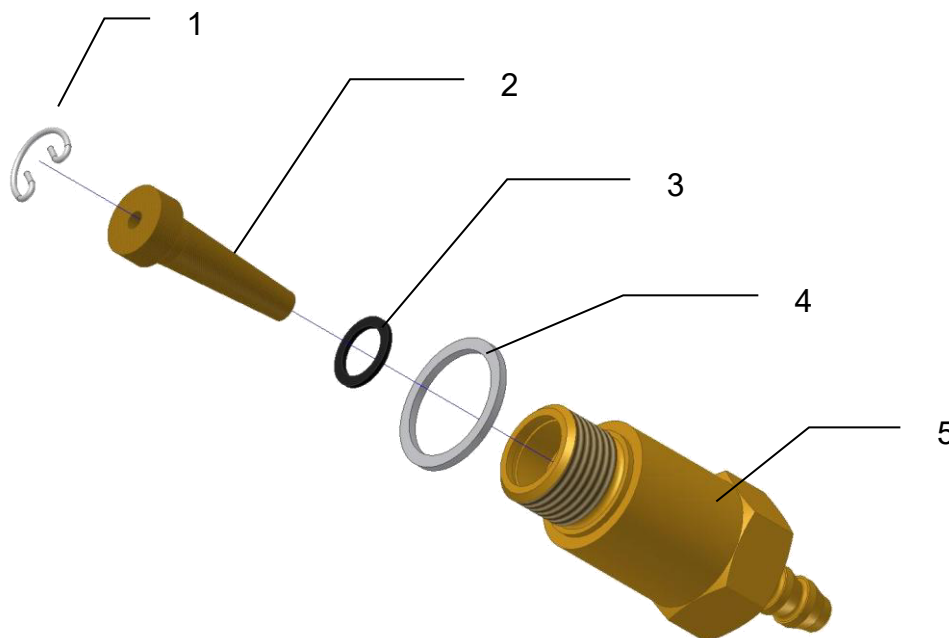
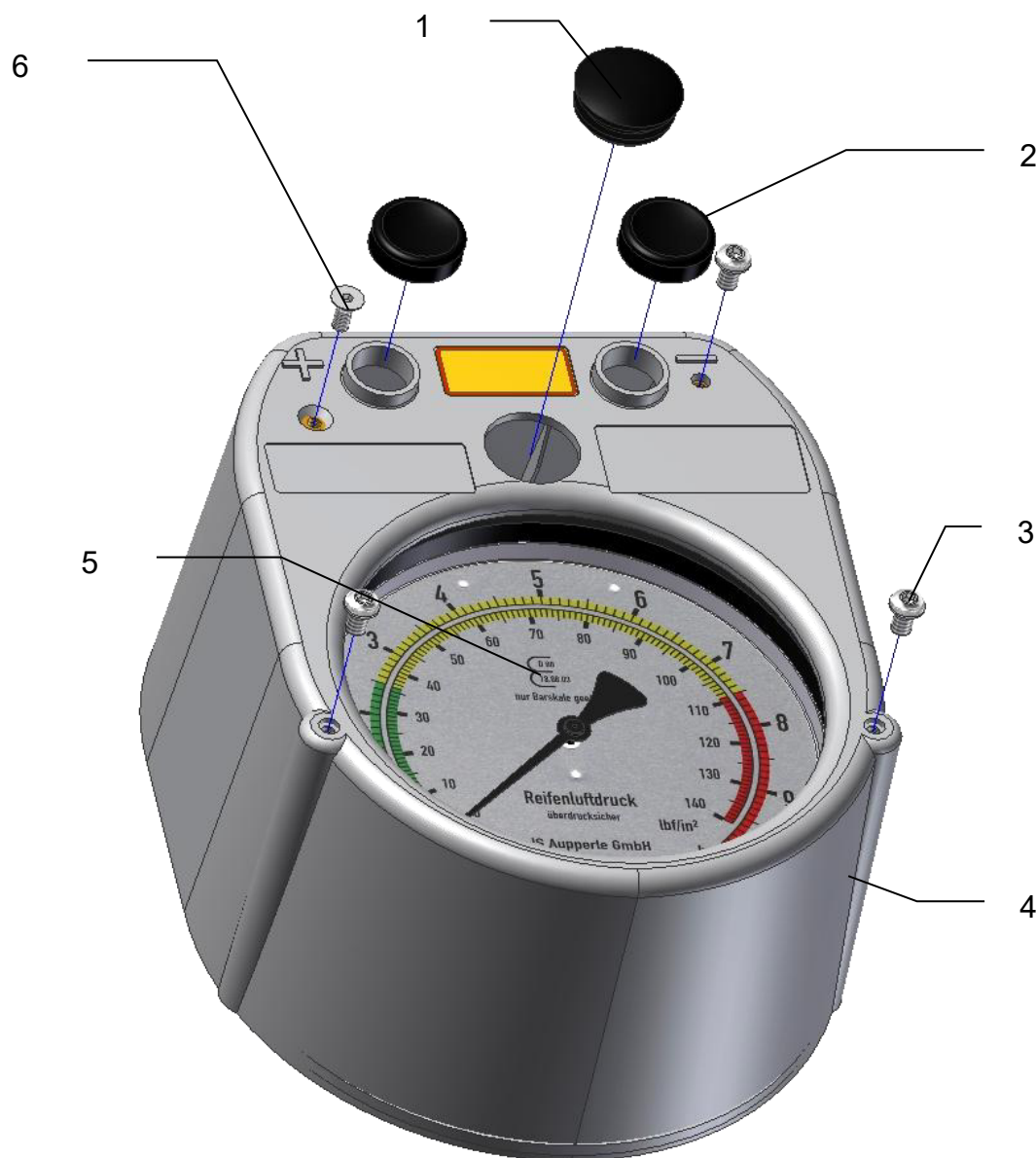

Image no.	Spare part article no.	Spare part designation	Quantity
1	2039048	Wire snap ring	1
2	5062732	Metal filter	1
3	5166152	Flat gasket	1
4	1237015	Sealing ring	1
5	5062724	Hose nozzle complete	1
6	50683679	Hose	8 m



12.2 Spare parts protective cover



ALF - Station

Image no.	Spare part article no.	Spare part designation	Quantity
1	5800010	Lamella plugs	1
2	5062963	Push button	2
3	1238252	Fillister head screw	3
4	5800070	Grey protective cover	1
5	5094586	Pressure gauge 10 bar	1
6	5906282	Countersunk screw for protective cover	1

12.3 Spare parts control housing

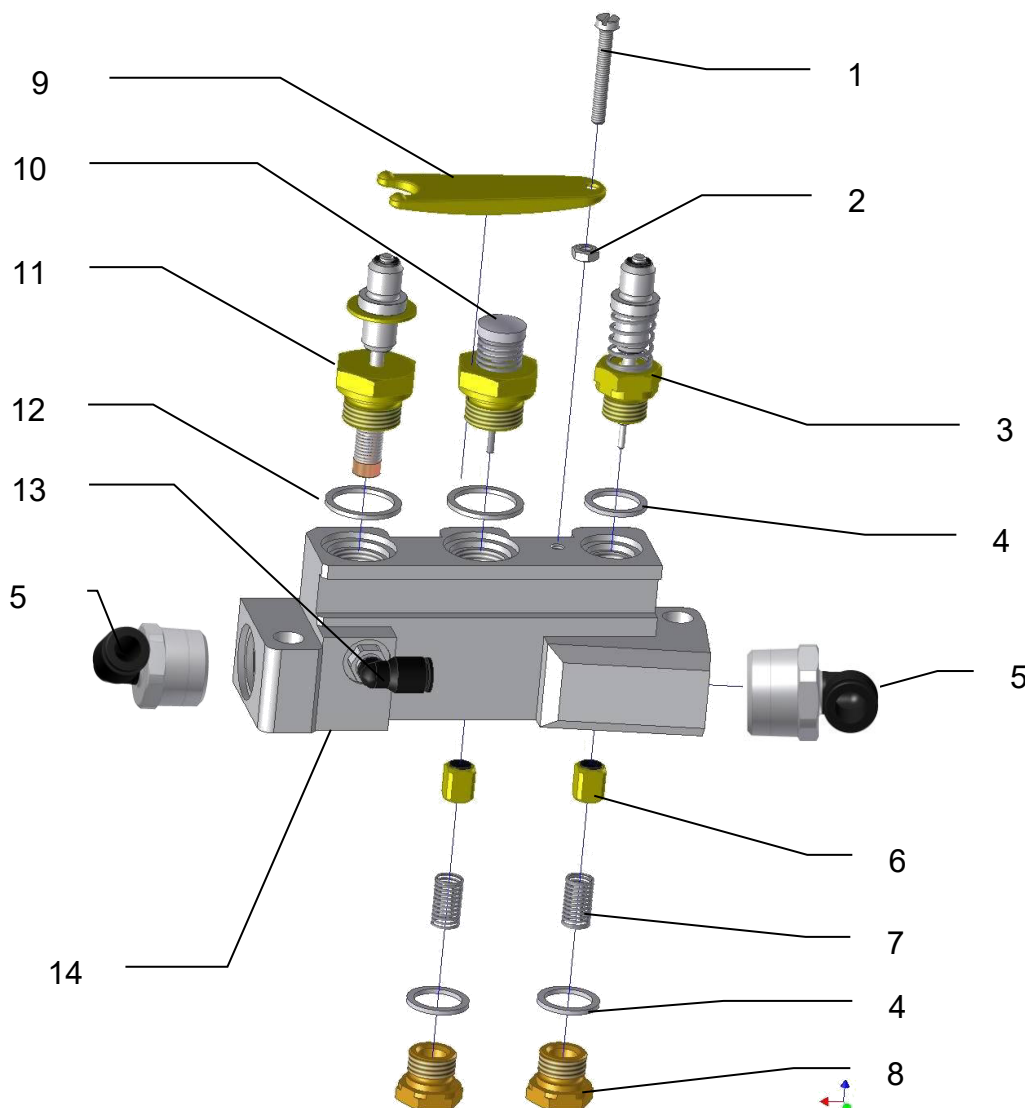

Image no.	Spare part article no.	Spare part designation	Quantity
1	1238203	Cheese head screw	1
2	1030170	Hexagon nut	1
3	5063268	Complete drain button	1
4	1236991	Sealing ring	3
5	5800260	Angle screw-in fastener 3/8"	2
6	5062898	Valve body complete	2
7	5062591	Compression spring small	2
8	5062823	Screw plug	2
9	5062807	Sheet metal lever	1
10	5063276	Test button complete	1
11	5063284	Filler button complete	1
12	1237015	Sealing ring	2
13	5275201	Angle screw-in fitting	1
14	5068713	Empty control housing	1
	5063326	Complete control housing	1



Further products and our
spare parts shop can be found at:
www.js-aupperle.de