

# ***Operating instructions***

## ***ALF - Tronik***



JS Aupperle GmbH - Untere Wängen 1 - D- 73119 Zell u. A.  
Phone: +49(0) 7164/ 14717-0





## 1 Table of contents

<b>1</b>	<b>Table of contents .....</b>	<b>1</b>
<b>2</b>	<b>Safety instruction.....</b>	<b>2</b>
2.1	Symbols and explanation .....	2
2.2	Work safety instructions .....	3
2.3	Safety regulations.....	4
2.4	Requirements for the installation .....	5
<b>3</b>	<b>General information .....</b>	<b>6</b>
3.1	Manufacturer / Type .....	6
3.2	Type approval .....	6
3.3	Copyright and industrial property rights.....	6
3.4	Labelling.....	6
3.5	Application.....	6
3.6	Description of the .....	7
3.7	Technical data.....	7
3.8	Note on the operating instructions.....	7
<b>4</b>	<b>Installation / set-up .....</b>	<b>8</b>
4.1	Drilling templates.....	9
4.2	Connection options.....	11
4.3	Disassembly / connection from behind.....	12
4.4	Assembly.....	16
<b>5</b>	<b>Device description .....</b>	<b>17</b>
5.1	Optional payment systems .....	18
<b>6</b>	<b>Commissioning .....</b>	<b>19</b>
6.1	Mandatory calibration .....	19
<b>7</b>	<b>Operation.....</b>	<b>20</b>
7.1	Tyre pressure correction .....	20
7.2	Empty tyre .....	21
7.3	Pressure unit.....	21
7.4	Zero point adjustment.....	21
<b>8</b>	<b>Maintenance/ repair .....</b>	<b>22</b>
8.1	Annual inspection and calibration test.....	22
8.2	Calibration device connection .....	23
	Error messages.....	24
8.3	Maintenance/ repair.....	25
8.4	Maintenance.....	25
8.5	Repair.....	25
<b>9</b>	<b>Guarantee .....</b>	<b>26</b>
<b>10</b>	<b>Take-back and recycling .....</b>	<b>27</b>
<b>11</b>	<b>Spare parts .....</b>	<b>28</b>
11.1	Spare parts.....	29

11.2	Spare parts.....	30
11.3	Spare parts list .....	31





## 2 Safety instruction

### 2.1 Symbols and explanation



#### Occupational safety symbol

This symbol is used for all work safety instructions in these operating instructions where there is a risk to the life or health of persons. These instructions must always be followed very carefully. All work safety instructions must be passed on to other users. In addition to the instructions given in the operating instructions, all other generally applicable safety and accident prevention regulations must also be observed.



#### Caution.

This "Caution" notice appears in all passages of these operating instructions that must be carefully observed in order to follow the guidelines, regulations, instructions and correct operating procedures and to prevent damage to the product and/or persons



#### Note

This note "Note" appears in all passages of these operating instructions that must be carefully observed. To prevent damage to the product and parts of the appliance, always follow the guidelines, regulations and instructions in the operating instructions.



## 2.2 Work safety instructions

The **ALF® - Tronik** has been developed and built in accordance with the relevant basic health and safety requirements set out in the EU directives.

### Hint



***This product can be dangerous if used improperly. Children must not operate this appliance. Incorrect operation can cause the tyre to explode!***

All persons involved in the maintenance, commissioning and operation of the **ALF® - Tronik** must read and understand the entire operating instructions beforehand.

### Hint



***The ALF® - Tronik tyre inflator is intended exclusively for compressed air / nitrogen. Any use outside this purpose as well as modifications to the product are considered improper use. The manufacturer is not liable for damage caused by improper use. The risk lies solely with the user.***

Proper use of the product also includes compliance with the manufacturer's instructions with regard to installation, operation and maintenance.

All work in connection with installation, adjustment and maintenance must be carried out by qualified personnel. When operating **ALF® - Tronik** tyre inflator, all local safety and accident prevention regulations must always be observed.

**ALF - Tronik**



## 2.3 Safety regulations

### Hint

---

The operator must monitor that:

- *the occupational health and safety and accident prevention regulations as well as the occupational health and safety regulations of these operating instructions are fully complied with in all measures*
- *Measures to avoid danger must be taken immediately!*

The operator of the tyre inflation gauge must ensure that:

- *the operating instructions can be inspected at the place of use by the persons responsible for operation*
  - *knowledge of the operating instructions must be a prerequisite for operating the tyre inflation gauge*
  - *any faults that occur must be reported to the operator*
  - *Persons who carry out maintenance work on the tyre inflation gauge are expressly authorised and qualified to do so*
  - *the safety, occupational health and safety and hazard notices on the appliance or place of use are in a clearly legible condition*
  - *no unauthorised conversions or modifications that could lead to improper use are carried out by persons entrusted with the operation or maintenance of the appliance*
  - *a decommissioned tyre inflator must be secured by the operator against unauthorised use*
- 







## 2.4 Requirements for the installation



### Caution

***As the ALF® - Tronik is not explosion-proof, it must not be installed in potentially explosive atmospheres. The requirements of the hazardous area standards for your local region must be observed.***



### Caution

***For column-mounted appliances, the compressed air and power lines must be routed through the floor into the base or rear of the column. For wall-mounted appliances, the compressed air and power lines are routed from the support wall to the base of the appliance.***



### Caution

***The ALF® - Tronik may only be operated with filtered, de-oiled and dried compressed air. The compressed air supply must therefore be equipped with the necessary compressed air maintenance unit. This includes the cyclone effect in the air filter housing for separating coarse mechanical particles and condensed water, the air filter with depth filter insert for separating fine mechanical particles and the pressure reducer. Furthermore, an air dryer must be installed in the air flow direction. The air dryer must realise a pressure dew point of the compressed air of at least the ambient temperature up to which the ALF® - Tronik is to be operated. The ALF® - Tronik must not be used to inflate and test water-filled ballast tyres or tyres treated with corrosive agents.***

## 3 General information

### 3.1 Manufacturer / Type

**JS Aupperle GmbH**  
Untere Wängen 1  
D - 73119 Zell u. A.  
Type: **ALF® - Tronik**

### 3.2 Type approval

The **ALF® - Tronik** tyre pressure gauge has been type-tested by the Physikalisch - Technische - Bundesanstalt and approved.

Type examination:

EN-25-M-PTB-0036

Tyre inflator **ALF- Tronik TS, TSS, OEM**

### 3.3 Copyright and industrial property rights

The copyright to these operating instructions remains with the manufacturer. Furthermore, all rights are reserved, in particular in the event that a patent is granted or a utility model is registered. Infringements are subject to compensation.

### 3.4 Labelling

<b>Metrological labelling:</b>	Is overlapping on the type plate on the right or left side next to the technical data
<b>Type examination:</b>	EN-25-M-PTB-0036

### 3.5 Application

- The tyre inflation gauge referred to in the operating instructions may only be used to check, inflate and deflate tyres for motor vehicles (it is **not suitable** for tyres on bicycles, children's vehicles, wheelbarrows and aircraft, for example).
- The compressed air specifications available at the place of use must be observed, as well as those of the tyre and vehicle manufacturers (e.g. posted table regarding inflation pressures depending on tyre size and load).



## 3.6 Description of the

The **ALF® - Tronik** is an automatic tyre inflator. The desired inflation pressure can be preselected using the +/- buttons.

The actual and target values are displayed on a 3 cm liquid crystal display. After connecting to a tyre, it is automatically corrected to the set value. A signal tone sounds when the nominal/target value is reached.

## 3.7 Technical data

<b>Height:</b>	Wall: 350 mm Column: 1520 mm
<b>Width:</b>	300 mm
<b>Depth:</b>	Wall: 130 mm Column: 240 mm
<b>Tension:</b>	230V 50/60Hz
<b>Protection class:</b>	IP45
<b>Power consumption during operation:</b>	max. 18VA
<b>Pressure supply:</b>	max. 16 bar / 231 psi / 1599 kpa
<b>Max. filling pressure:</b>	10.0 bar / 145 psi / 999 kpa
<b>Max. deviation:</b>	< 0.08 bar/ 1.16 psi / 8 kpa
<b>Hose length:</b>	8 metres
<b>Supply connection:</b>	Column: 1/2 inch, Wall version: 3/8 inch
<b>Temperature range:</b>	- 10°C to +40°C
<b>Valid standards:</b>	EC Directive 2004/108/EC (EMC Directive) EC Directive 2006/95/EC Low Voltage Directive
<b>Options:</b>	Payment systems

## 3.8 Note on the operating instructions

### Hint

*For reasons of clarity, these operating instructions do not contain all the detailed information on the tyre inflation gauge*

*ALF® - Tronik (Aupperle - Air - Filler).*

*If you require further information or if specific problems arise that are not covered in sufficient detail in these operating instructions, you can request the necessary information directly from the manufacturer (see cover sheet).*



*We would also like to point out that the content of these operating instructions is part of an existing agreement or legal relationship. All obligations arise from the respective purchase contract, which also contains the complete and solely valid warranty and liability regulations.*



## 4 Installation / set-up

### Caution



***To ensure trouble-free operation, the power supply from the main switchboard must be protected with a max. 10 ampere fuse and an RCD. The appliance must be earthed.***

***The RCD must be marked as a disconnecting device for the appliance.***

***The ALF® - Tronik is designed for operation inside and outside buildings.***

### Hint



***The air compressor and the compressed air system must be equipped with the necessary compressed air maintenance units, including an air dryer, to prevent dirt and water from accumulating in the ALF® - Tronik pipe system.***

***The ALF® - Tronik must not be used for filling and testing ballast tyres filled with water or tyres treated with corrosive agents.***

### Hint



***The column version must be installed on the floor and screwed in place using the four self-tightening screws supplied.***

### Hint



***The wall-mounted appliance must be fixed to the wall with four screws.***



## 4.1 Drilling templates

Please fix the column to the ground using the ground anchors supplied.

### Technical data:

Drill hole diameter: 10 mm  
Min. drill hole depth: 110 mm  
Width across flats: 17 mm

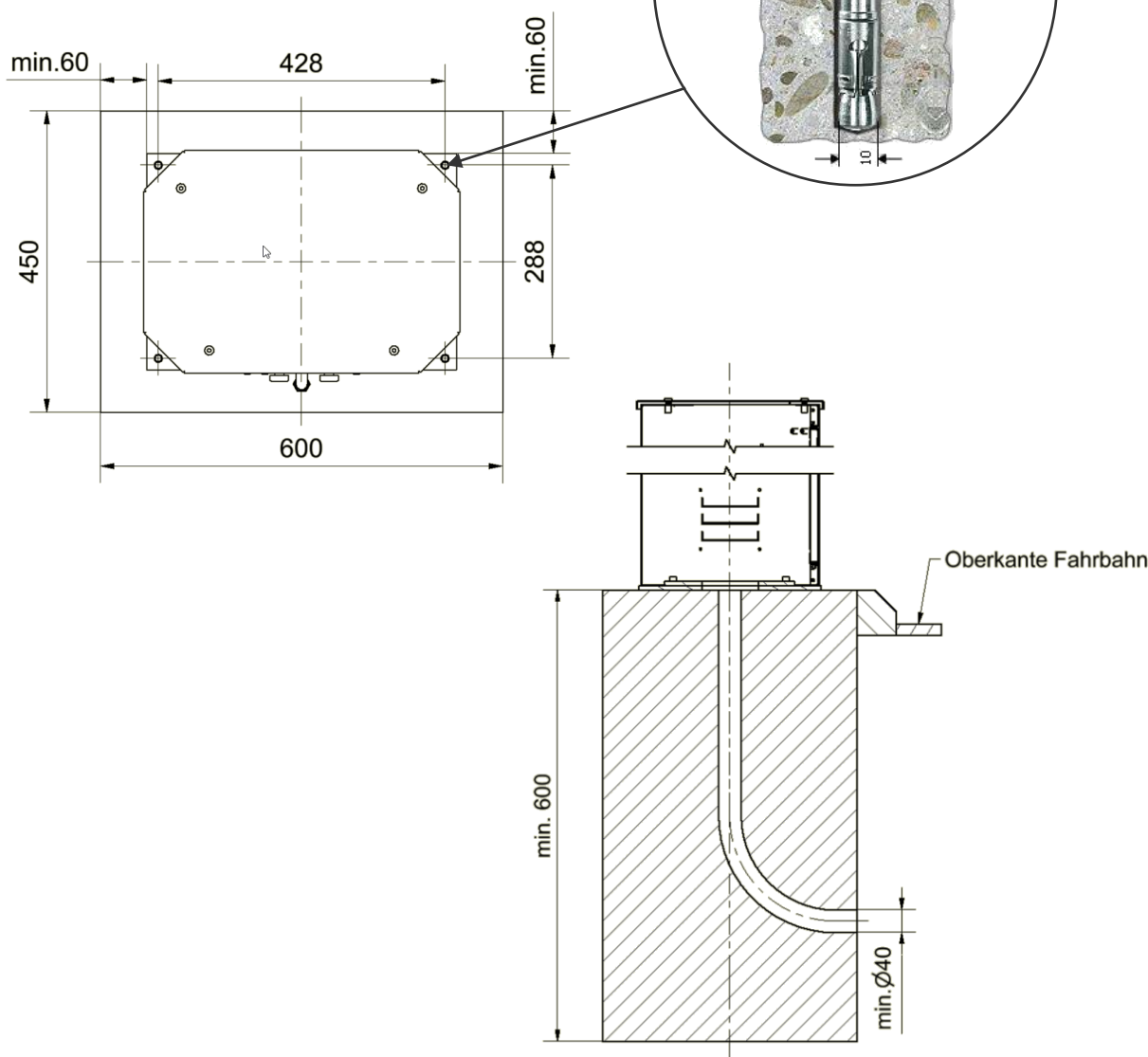

To ensure that the column is stable, the foundation must correspond to the dimensions specified above.

In the centre of the foundation, there should be an empty conduit with a minimum Ø of 40 mm the water, air and power lines to pass through.

This empty conduit must be sealed watertight on the house side.

The inserted cable must end at least 2 metres above the foundation.

**ALF - Tronik**



# ALF - Tronik

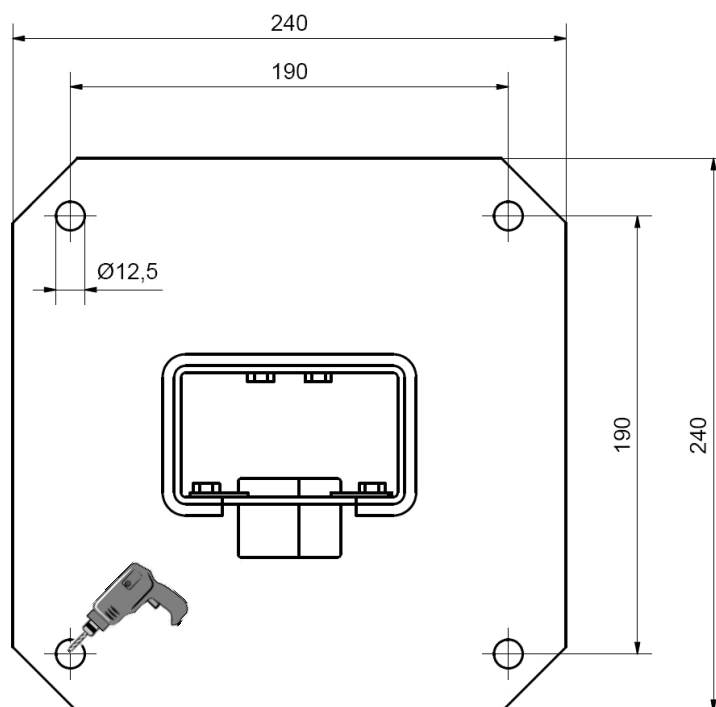

Drilling template ALF® - Tronik column  
(These drawings are not to scale)

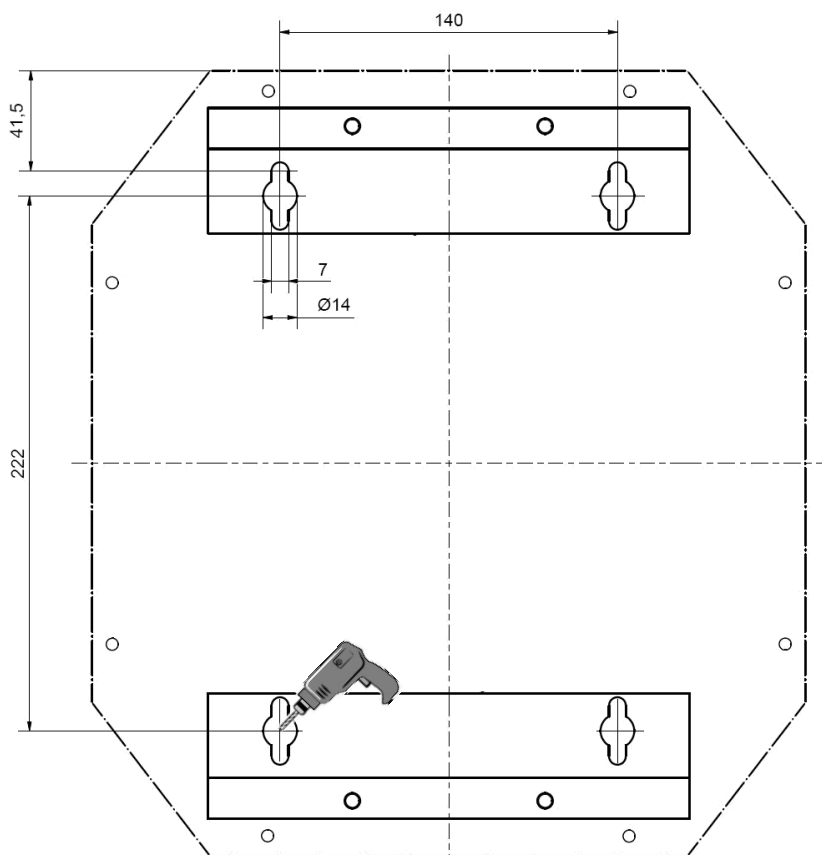

Drilling template ALF® - Tronik wall unit

Fix the appliance to a solid wall using four 8 mm diameter wall plugs and four suitable screws.



### 4.2 Connection options

#### Hint



***Before starting installation, make sure that the connection cable is de-energised and the compressed air line is depressurised.***

With the **ALF® - Tronik**, you have the option of supplying the device with compressed air and power from below or from behind.

A connection from below is provided ex works.

If you do not have a connection option from below, please follow points 1 to 3.3 under 4.3 Dismantling / connection from behind.

**ALF - Tronik**



## 4.3 Disassembly / connection from behind

### Hint



***Before starting disassembly, please disconnect the ALF® - Tronik from the power and compressed air supply. Please ensure that the supply line is no longer pressurised.***

1. remove the rectangular black cover cap.

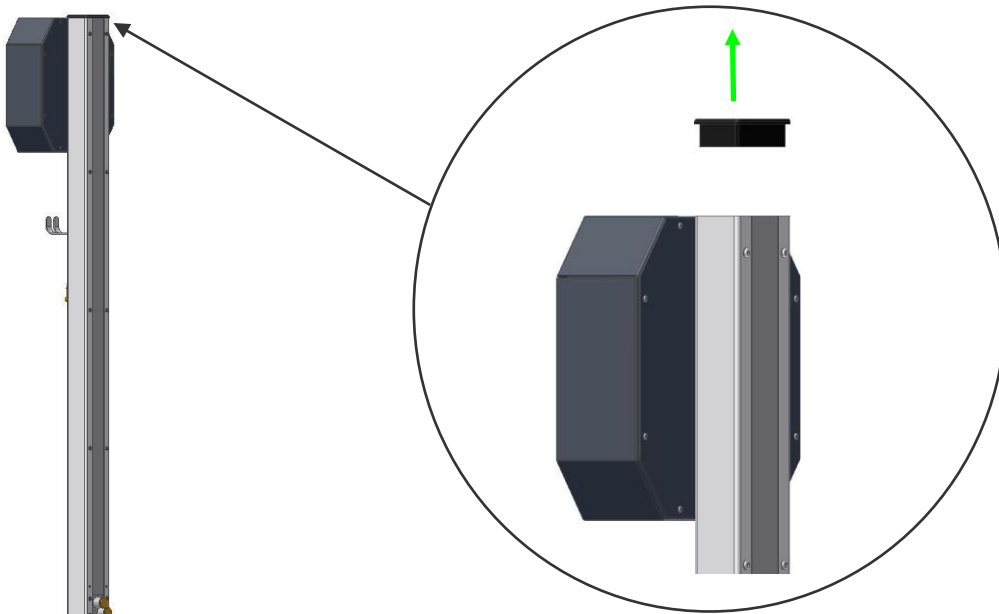

2. use the special spanner supplied to unscrew the 10 screws on the back of the cover, cover on the back using the special spanner supplied.

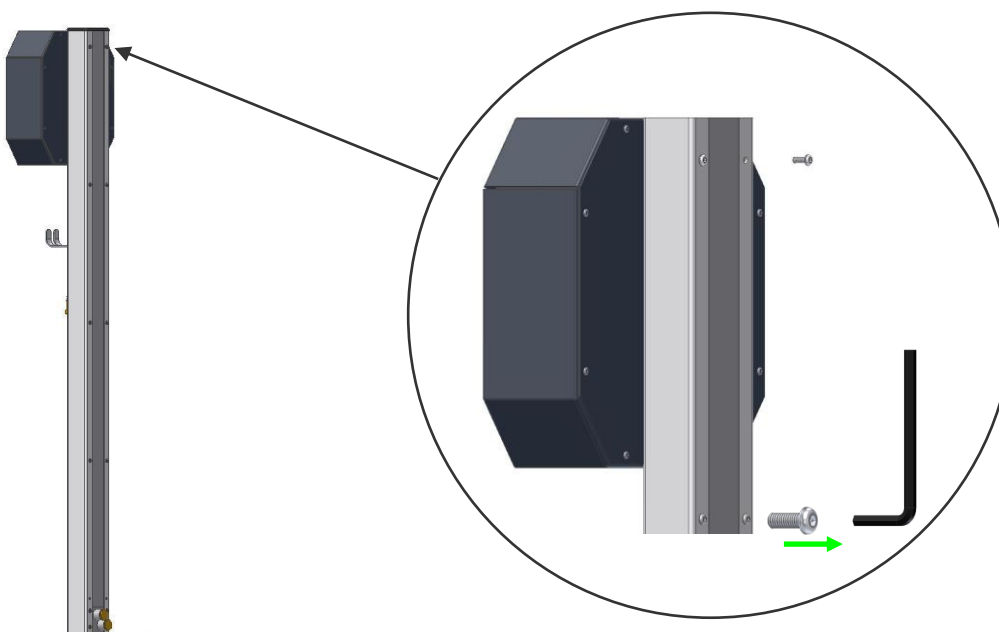

**ALF - Tronik**





3 Now pull the cover upwards out of the column.

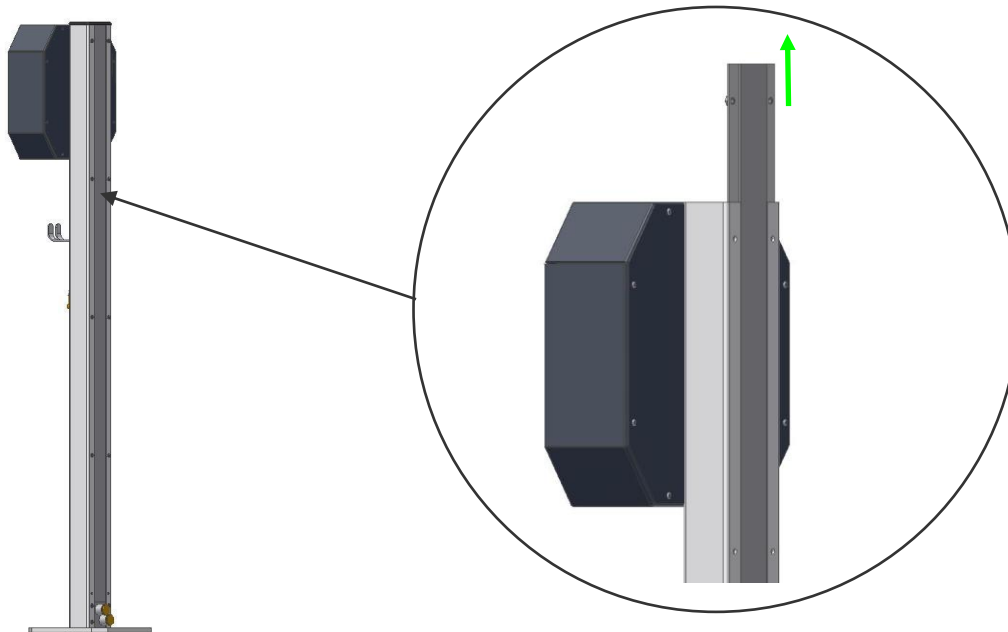

3.1 Insert the pneumatic hose hanging downwards out of the column into the pneumatic fitting. Pneumatic screw connection.

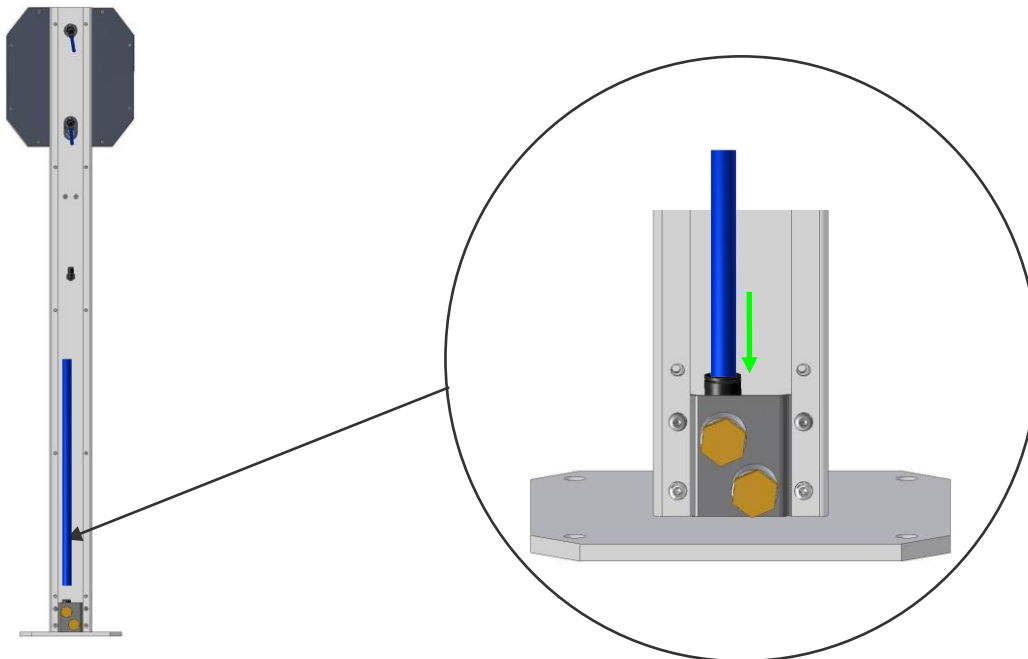

**ALF - Tronik**



3.2 Remove the upper screw plug from the sleeve.

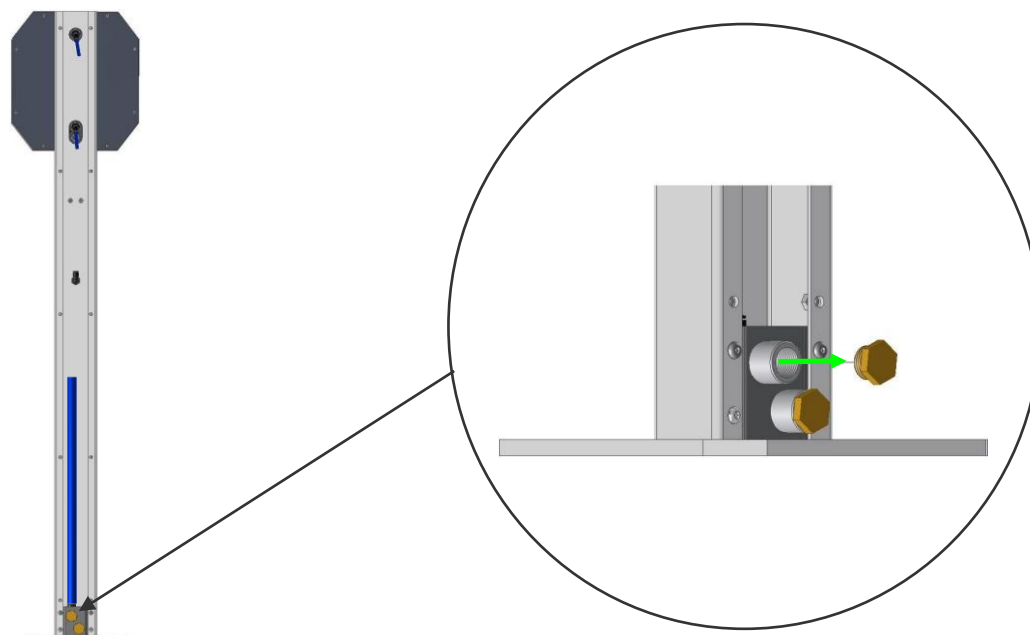

3.3 Screw your pressure connection into the 1/2" socket.  
The lower sleeve can be used to feed through the connection cable. be used.

4. remove the two pneumatic hoses from the pneumatic. Pneumatic screw connections at the rear of the **ALF® - Tronik**.

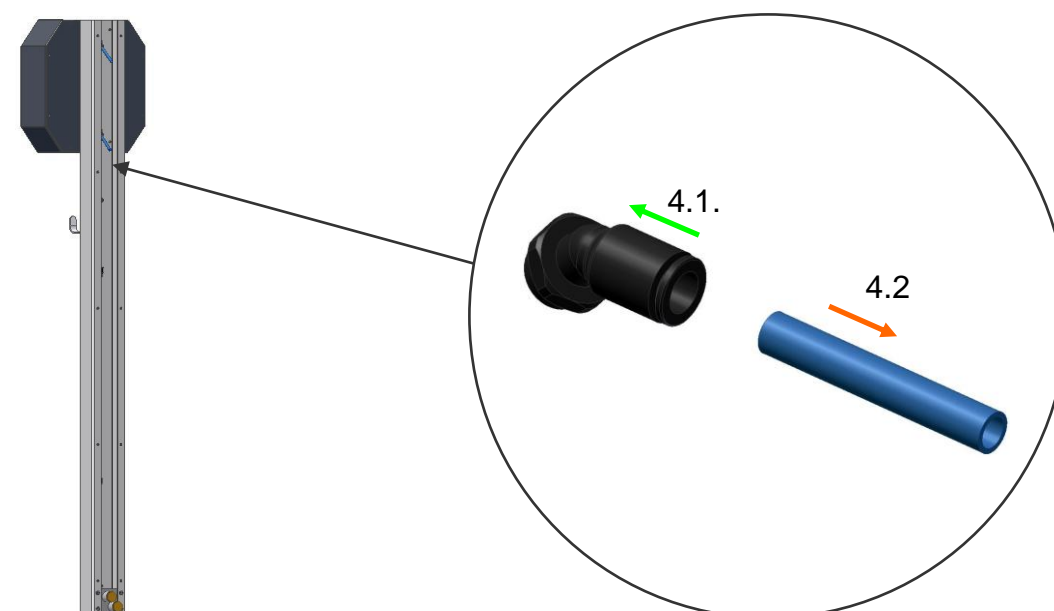

4.1 To do this, push the ring (black) at the lower end of the pneumatic  
pneumatic screw connection upwards and hold it there.

4.2 Now pull the pneumatic hose (blue) out of the pneumatic fitting with the other  
hand.

the pneumatic screw connection.



5. loosen the plug connection on the mains plug in the column.
6. use the special spanner supplied to remove the 4 fixing screws on the back of the fixing screws on the back of the **ALF® - Tronik**.



### Caution

**The ALF® - Tronik can fall down when the last screw is loosened.**

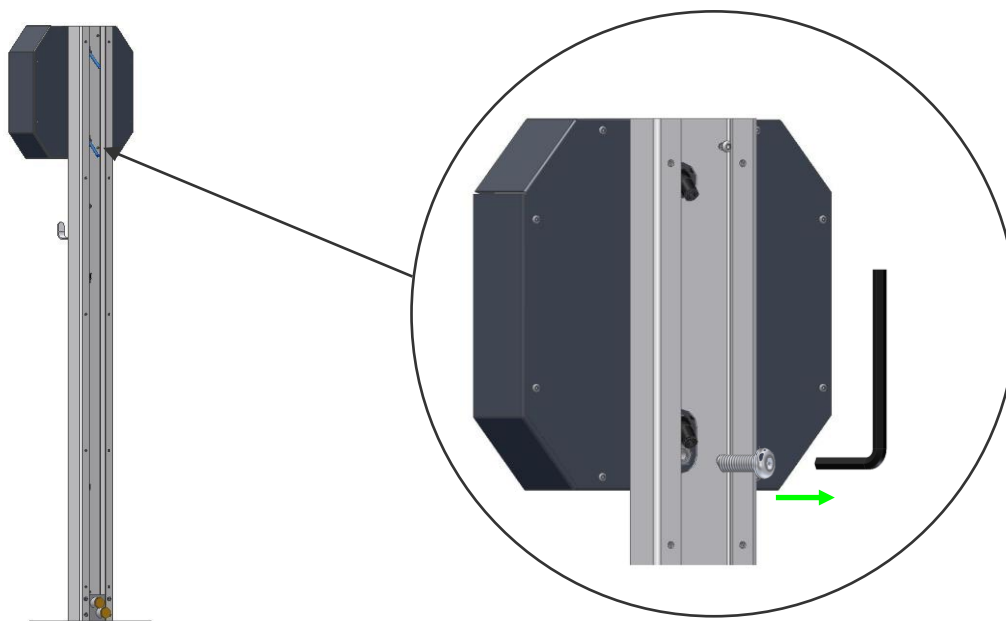

7. remove the ALF® - Tronik towards the front.

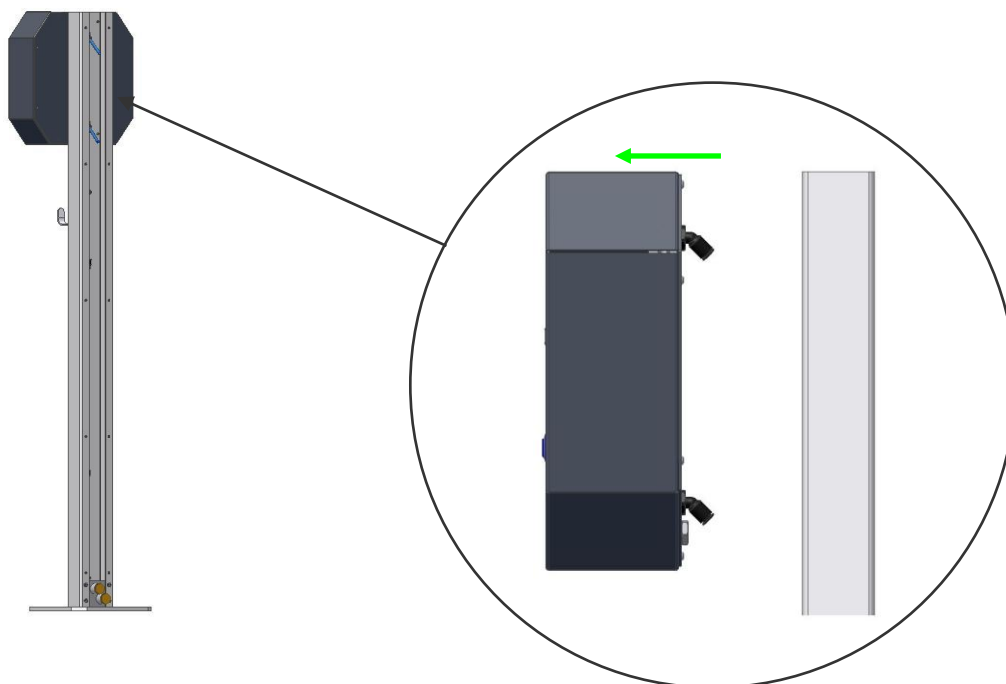

**ALF - Tronik**



#### 4.4 Assembly

To reattach your **ALF® - Tronik** to the column, please follow points 1 to 7 of section 4.3 Dismantling in reverse order.

**ALF - Tronik**



## 5 Device description



### LCD display

3½ digit display for  
Target pressure (top) and actual  
pressure (bottom)

### Compressed air connection 3/8"

For the filling hose

### Cable gland

For power supply and  
connection to the mains.

### Compressed air connection 3/8"

For pressurised supply  
max. 16 bar

### Illuminated control buttons

For setting the desired  
pressure value.

**ALF - Tronik**



## 5.1 Optional payment systems

### Hint



If you have a device with a coin acceptor and "PAY" is shown in the upper display, all operating buttons are locked. You can unlock them by inserting a coin printed on the coin acceptor or by contactless payment.





## 6 Commissioning

After connecting the power and air supply to the tyre inflator, ensure the following:

1. For efficient tyre inflation operation, the supply air pressure must be at least 0.7 bar or 10 psi or above the intended maximum inflation range.
2. After switching on the **ALF® - Tronik**, the display immediately shows all LCD digits. The software version, e.g. 1.1.1, and the subsequent firmware version, e.g. 4.2.0, are then displayed.
3. The device blows off briefly and then returns to the set preset pressure (SET). The inflation hose must not be connected to the tyres when starting up the **ALF® - Tronik**, otherwise an error (E6) will be caused.

### 6.1 Mandatory calibration

The calibration law applies with regard to calibration and test intervals. In the Federal Republic of Germany, measuring devices for checking tyre pressure must be calibrated in accordance with the calibration law of 23.03.1992 (last amended on 03.07.2008). The period of validity of the calibration is 2 years after the end of the calendar year in which the tyre pressure gauge was last calibrated. The person who uses or keeps the tyre pressure gauge available is responsible for the calibration (Eichgesetz § 35 [2], 1).



## 7 Operation



### Note

**Please refer to your vehicle's operating instructions for the correct tyre pressure.**

### 7.1 Tyre pressure correction

With the ALF® - Tronik you can have the tyre pressure corrected fully automatically.

1		Check the operating instructions for your vehicle to see what air pressure is prescribed.
2		Use the + and - buttons to set the desired pressure.
3		Confirm the set pressure with the OK button.
4		Connect the inflation hose to the tyre valve.
5		<p>The filling process now starts automatically.</p> <p>The compressor starts on versions with a built-in compressor.</p> <p><b>You can cancel the process at any time by pressing any button</b></p>
6		Once the correction is complete, a beep sounds at short intervals.
7		Pull off the filling hose.

You now have 2 minutes to correct the second tyre on the same axle. To do this, repeat the procedure from point 4.

If you want to correct the tyre pressure of the other axle, you must repeat the procedure from point 1.

After 2 minutes of inactivity, the device automatically switches to 2.00 bar.





## 7.2 Empty tyre

If the tyre is completely deflated, you must carry out the following points:

1		Check the operating instructions for your vehicle to see what air pressure is prescribed.
2		Use the + and - buttons to set the pressure.
3		Connect the inflation hose to the tyre valve.
4		Confirm the set pressure with the OK button <b>twice</b> . The ALF® - Tronik now attempts to build up counter-pressure with three successive blasts of air.
4.1		<b><i>If no back pressure is detected, the appliance switches off automatically.</i></b>
5		The filling process now starts automatically. <b><i>You can cancel the process at any time by pressing any button.</i></b>
6		Once the correction is complete, a beep sounds at short intervals.
7		Pull off the filling hose.

## 7.3 Pressure unit

You can switch the pressure unit to PSI by pressing the bar/PSI button.  
The second pressure unit is only displayed as long as you press the button.

## 7.4 Zero point adjustment

The **ALF® - Tronik** automatically performs a zero point calibration every hour. To do this, the drain valve is opened and the calibration is performed.  
While a process is running, it is postponed by one hour.



## 8 Maintenance/ repair

### 8.1 Annual inspection and calibration test

To inspect and check the actual tyre pressure (annual inspection or calibration check), carry out the following:



#### Caution

*Only a calibrated pressure gauge may be used as a reference for checking the ALF® - Tronik.*



#### Hint

In calibration mode, the ALF® - Tronik does not function as a tyre inflator.



#### Hint

If you have a device with a coin acceptor and "PAY" is shown in the upper display, all operating buttons are locked. You can unlock them by inserting a coin printed on the coin tester.



#### Hint

If you have a device with a coin acceptor and "PAY" is shown in the upper display, all operating buttons are locked. You can unlock them by inserting a coin printed on the coin acceptor or by contactless payment.

1. Press and hold the + and - buttons simultaneously until you hear a long beep.
2. Press the button+ 5 times.
3. In the upper display, the pressure resolution is changed from 0.1 bar to 0.01 bar.
4. Apply a test pressure to the plug nipple (max. 10 bar).
5. The displayed pressure value can now be compared with the applied test pressure using a calibrated test device
6. After pressing any button, the device returns to its normal display mode.



## Caution



If the pressure displayed in the ALF® - Tronik does not match the display in the reference pressure gauge, the ALF® - Tronik must no longer be used.  
It must be sent to the specialist dealer or manufacturer for inspection.

## 8.2 Calibration device connection

### Hint



*A calibration device can be borrowed from the manufacturer for a fee.*

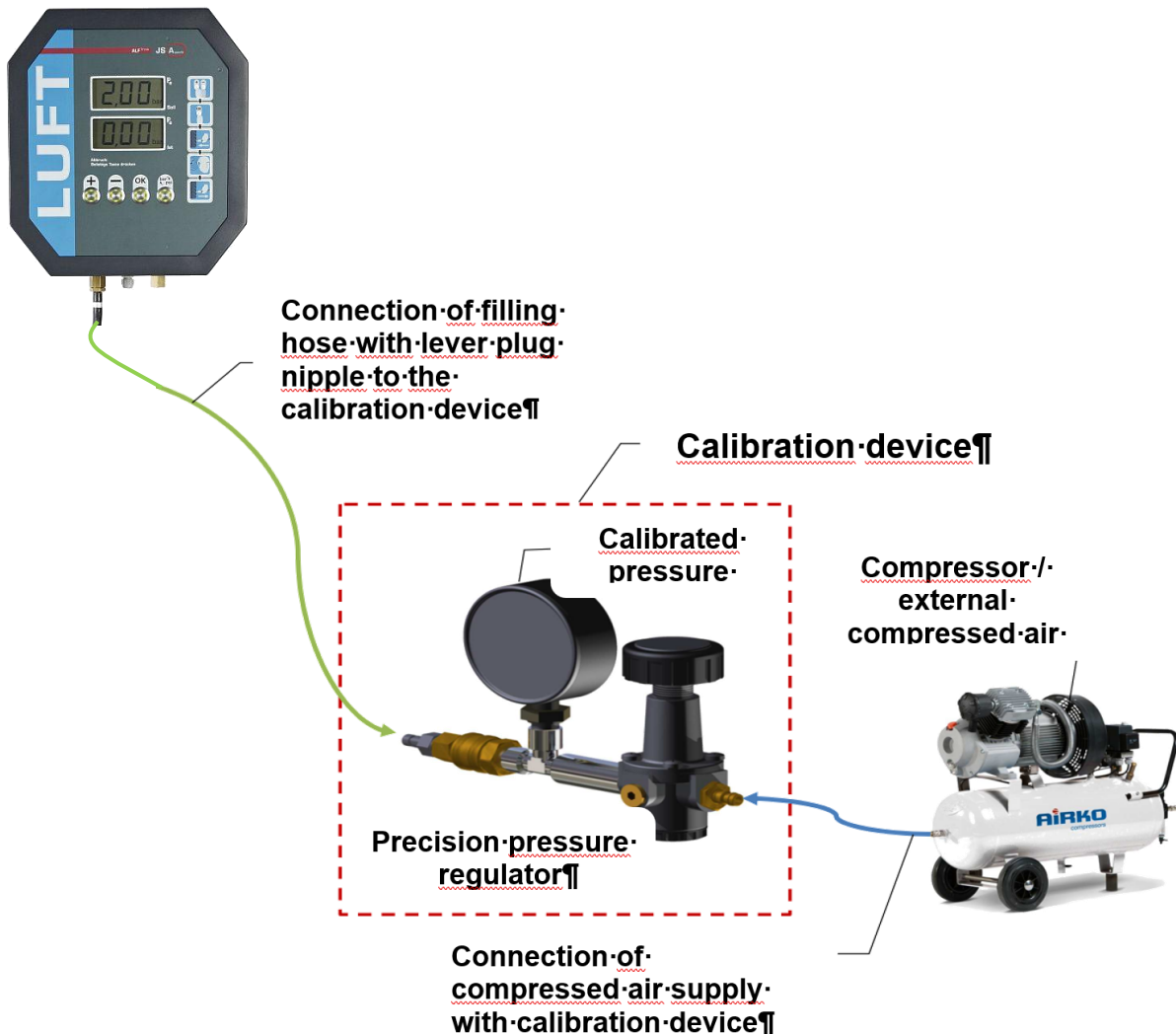

ALF - Tronik



## Error messages

Error no.	Cause	
E 1	Supply air unstable. Non-return valve defective.	
E 2	EEProm data corrupted.	Device is initialised with standard parameters
E 3	No supply air	
E 4	Sensor signal outside valid range.	
E 5	Solenoid valves defective.	
E 6	Sensor calibration not possible.	System start under pressure at the filling hose. Press the + button, the device performs a reset.
E 7	Operating voltage too low	
E 8	Operating voltage too high	
E 30	Insufficient volume	



## 8.3 Maintenance / Repair

The following parts do not require maintenance:

- Pressure transducer
- Electronic control unit / circuit board

### Hint



*If there are faults in these parts, they can only be replaced by a qualified person.  
Contact an authorised specialist dealer or the manufacturer.*

## 8.4 Maintenance

Period	Examination
Weekly	<ul style="list-style-type: none"><li>• Check the filling hose and plug nipple</li><li>• Check the compressed air connection</li></ul> <b>If leaks or wear are detected, replace damaged parts.</b>
Half-yearly	<ul style="list-style-type: none"><li>• Check tyre inflation gauge and compressed air connection for leaks.</li><li>• Is the calibration sticker on the appliance still valid? If not, a new calibration is required.</li></ul>
Annually	<ul style="list-style-type: none"><li>• Remove hose connections for air inlet/air outlet. Remove, clean or replace the coarse dirt filter.</li><li>• This cleaning must also be carried out if a slowdown in the filling time is detected.</li></ul>

## 8.5 Repair

The **ALF® - Tronik** has a national type approval and is subject to mandatory calibration in Germany and most EU countries. We therefore recommend sending the **ALF® - Tronik** to a specialist dealer or manufacturer in the event of faults or repairs.



## 9 Guarantee

The scope and period of the warranty are regulated in the manufacturer's terms and conditions of sale and delivery. The operating instructions valid at the time of delivery shall always apply to warranty and liability claims, unless otherwise agreed. The following applies in addition to the terms and conditions of sale and delivery: No warranty or liability is accepted for damage caused for the following reasons, insofar as this is permissible:

- Non-observance of the operating instructions.
- Parts that have been damaged by force by the customer or third parties.
- If the customer or a third party has tampered with or carried out unauthorised repairs to the appliance without our written consent.
- If additional equipment or operating materials not recommended by us have been used and the customer does not provide proof that the claimed defect is not due to this.
- If damage is caused by force majeure, water damage, fire damage or connection of the appliance to incorrect compressed air, water and power connections.
- By inadequately trained and insufficiently instructed operating and maintenance personnel of the operator.
- When using non-original spare parts.
- If the necessary maintenance and service work has not been carried out on a regular basis.
- If the safety regulations in sections 2.2 and 2.3 are not observed.
- If the product is not used as intended, or if it is incorrectly installed or commissioned, or if it is operated in an unauthorised manner.
- If intended use is not guaranteed and the tyre inflation gauge is not operated in accordance with the contractually agreed conditions of use.
- If the calibration seal has been damaged or removed.

**The operator must ensure compliance with these provisions:**

- That the safety regulations in accordance with sections 2.2 and 2.3 are complied with.
- That improper use, incorrect installation or commissioning and unauthorised operation are excluded and that, in addition
- Intended use is guaranteed and the tyre inflation gauge is operated in accordance with the contractually agreed conditions of use.



### 10 Take-back and recycling



#### Taking back old appliances

The adjacent symbol means that the old appliance must be disposed of separately from household waste. According to the Electrical and Electronic Equipment Act, owners of old appliances are required by law to dispose of old electrical and electronic equipment separately from household waste. Please help and make a contribution to environmental protection by not throwing the old appliance into the household waste.



#### Hint

*Appliances must not be disposed of with household waste. Please contact us for proper disposal. Telephone: +49(0)7164 - 14717 - 0*

## 11 Spare parts

**ALF - Tronik**

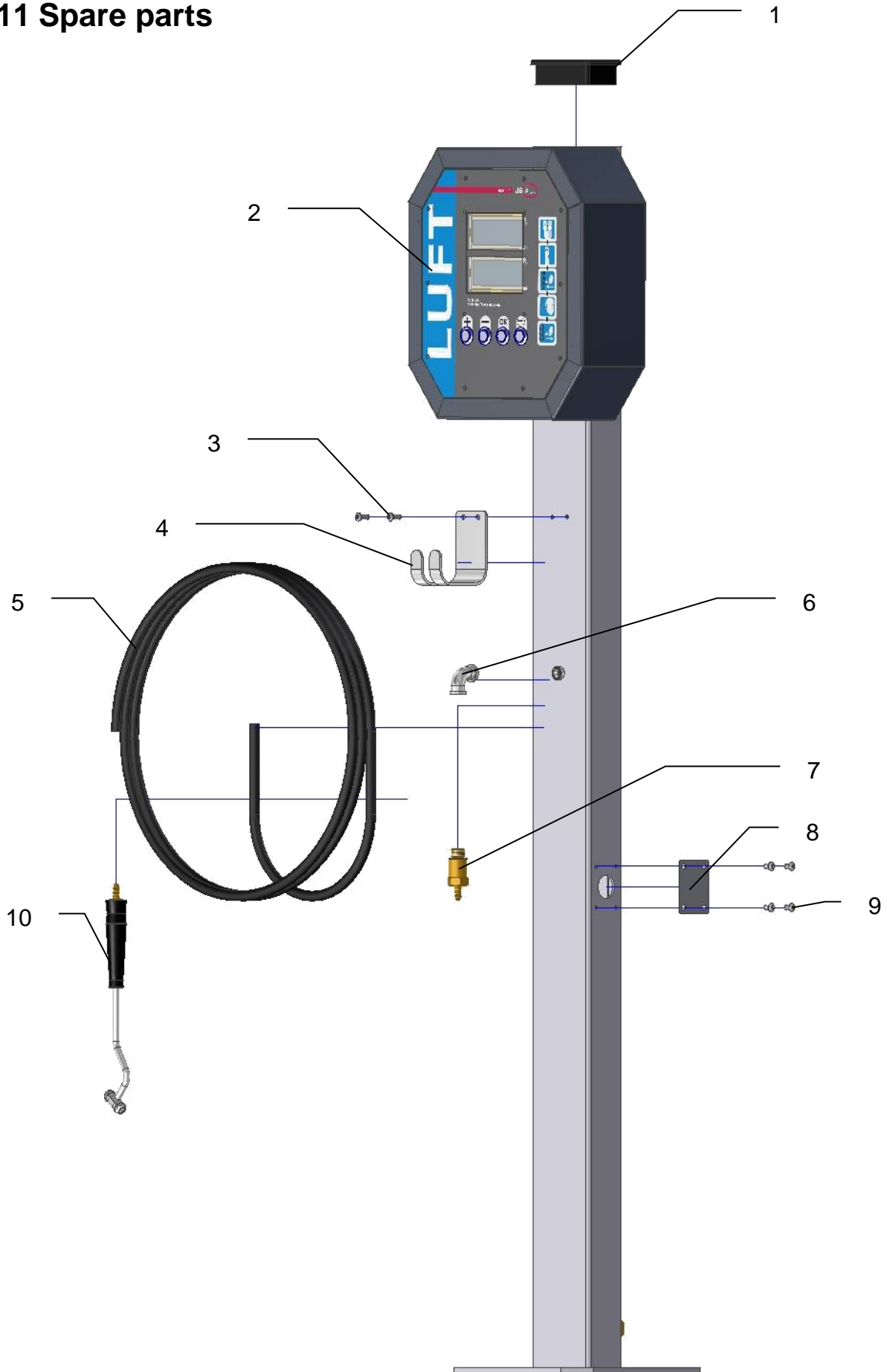





## 11.1 Spare parts

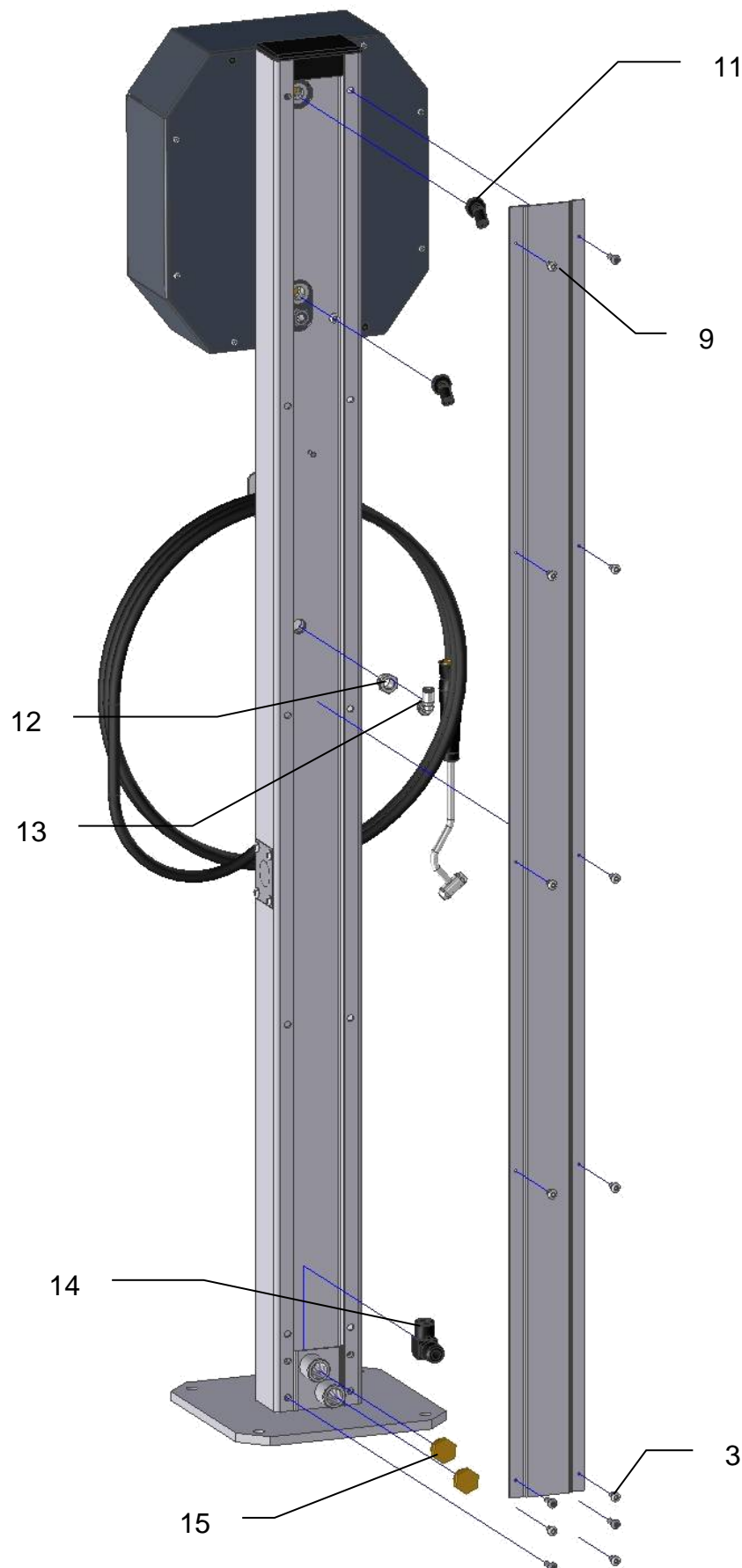

**ALF - Tronik**

## 11.2 Spare parts

**ALF - Tronik**

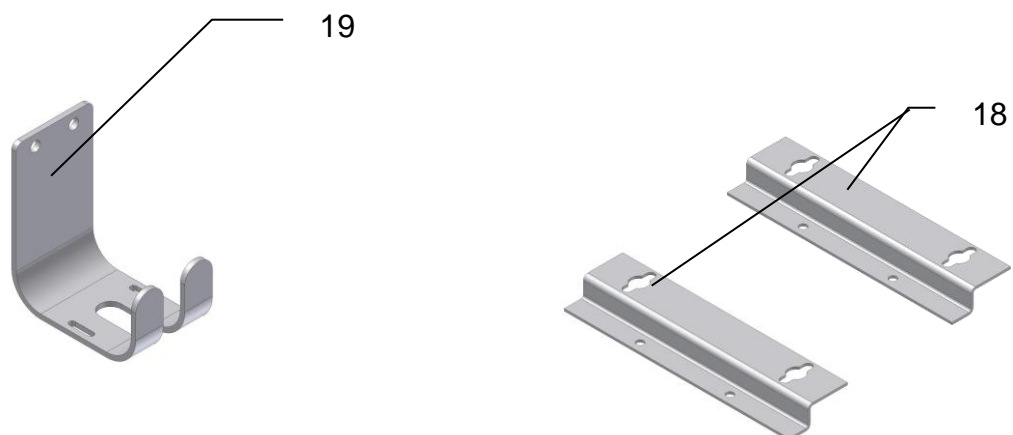
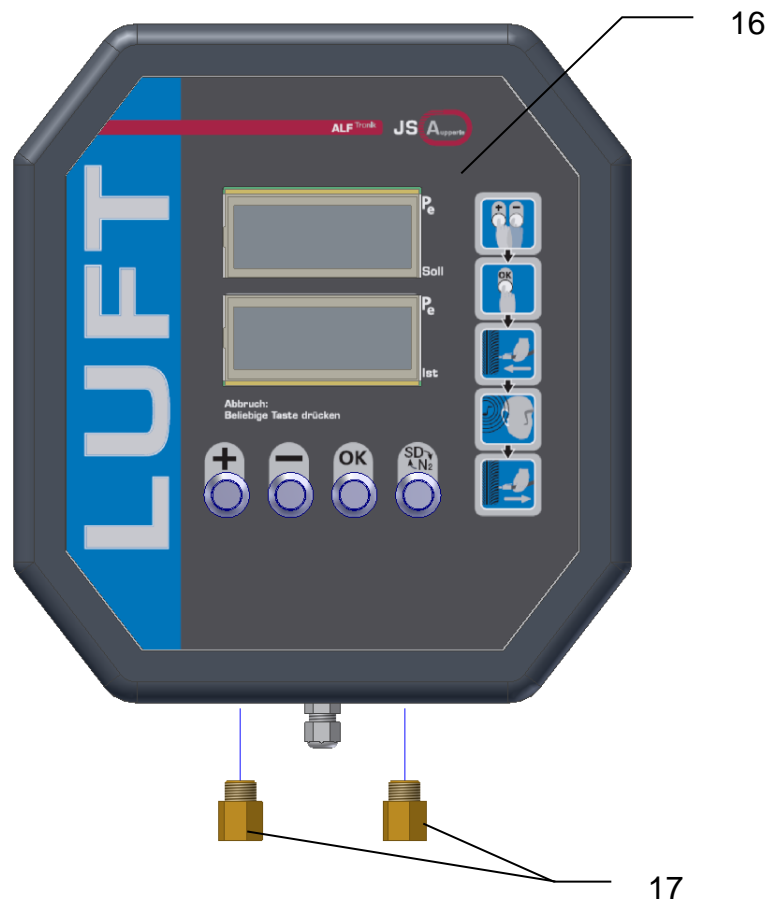



## 11.3 Spare parts list

Image no.	Spare part article no.	Spare part designation	Quantity
1	5906086	Cover	1
2	200 510	ALF- Tronik column filler	1
3	5906157	Pan head screw M6x 12	6
4	5900290	Hose holder	1
5	5068367	Hose section 8m	1
6	5906159	90° bend	1
7	5062724	Hose nozzle complete	1
8	5906276	Cover plate for ALF column	1
9	5906025	Pan head screw M6x10	18
10	5114814	Plug-in nipple ALF / Airfix I	1
11	5906125	Elbow push-in fitting 45°	2
12	5906254	Reduction AG 3/8" to IG1/4"	1
13	5906250	Angle screw-in fastener, rotatable	1
14	5906162	Elbow push-in fitting 1/2"-8	1
15	5906196	Screw plug 1/2"	2
16	200 500	ALF Tronik TS wall filler	1
17	5906108 and 5906109	3/8" reducer and filter	2
18	5906070	Wall mounting	2
19	5900290	Hose holder	1
	5906152	L- spanner for safety screws	1

**Further products and our  
spare parts shop can be found at:**  
[www.js-aupperle.de](http://www.js-aupperle.de)

**ALF - Tronik**